

檢驗設備 Verification Set



Metallurgical Microscope
(With Digital Camera)
金相顯微鏡



Charpy Impact
Testing Machine
沖擊試驗機

Universal Testing Machine
(Tensile, Yield Strength...etc)
拉伸試驗機



Spectrometer
光譜分析儀

生產流程 Production Flow Chart



Design
設計



Wax Injection
射蠟



Dipping
浸漿



Pouring
澆鑄



Dewax
脫蠟



Drying
乾燥



Shot Blasting
噴砂



CNC Lathe Machining
CNC加工



CNC Milling Machine Machining
CNC 銑床加工



Finished Product Assembly
組裝, 裝配



Ball Machining
鋼球加工



Tapping
攻牙



Pressure Testing
壓力測試



Packing Of The Final Product
成品包裝

目录 CONTENTS



● 800LB 鍛鋼閘閥 800LB FORGED STEEL GATE VALVE	1	● 對夾式防結露蝶閥(齒輪式操作) WAFER TYPE ANTI-DEW BUTTERFLY VALVE (WORM GEAR OPERATION)	17
● 800LB 鍛鋼截止閥 800LB FORGED STEEL GLOBE VALVE	2	● 對夾式防結露蝶閥(手柄式操作) WAFER TYPE ANTI-DEW BUTTERFLY VALVE (LEVER OPERATION)	18
● 800LB 鍛鋼旋啟式止回閥 800LB FORGED STEEL SWING CHECK VALVE	3	● 對夾式偏心蝶閥(齒輪式操作) WAFER TYPE ECCENTRIC BUTTERFLY VALVE (WORM GEAR OPERATION)	19
● 800LB 鍛鋼升降式止回閥 800LB FORGED STEEL PISTON CHECK VALVE	3	● 對夾式偏心蝶閥(手柄式操作) WAFER TYPE ECCENTRIC BUTTERFLY VALVE (LEVER OPERATION)	20
● PN 1.6 Mpa 法蘭閘閥(Z41型) GATE VALVE PN 1.6 Mpa FLANGE END	4	● 多耳式蝶閥(手柄式操作) LUG TYPE BUTTERFLY VALVE(LEVER OPERATON)	21
● PN 1.6 Mpa 法蘭截止閥(J41型) GLOBE VALVE PN 1.6 Mpa FLANGE END	4	● 多耳式蝶閥(齒輪式操作) LUG TYPE BUTTERFLY VALVE(WORM GEAR OPERATION)	22
● PN 1.6 Mpa 法蘭止回閥(H44型) SWING CHECK VALVE PN 1.6 Mpa FLANGE END	4	● 對夾雙瓣式止回閥 WAFER TYPE DUAL-PLATE CHECK VALVE	23
● PN 1.6 Mpa 法蘭截止閥(J41型) GLOBE VALVE PN 1.6 Mpa FLANGE END	5	● 安全閥 TC-1000L CAST BRONZE BRONZE SAFETY VALVE WITH LEVER	24
● PN 4.0 Mpa 法蘭截止閥(J41型) GLOBE VALVE PN 4.0 Mpa FLANGE END	6	● 安全閥 TC-1000S CAST BRONZE BRONZE SAFETY VALVE WITH SEALING	24
● PN 1.6 Mpa 法蘭閘閥(Z40型) GATE VALVE PN 1.6 Mpa FLANGE END	7	● 鑄鐵蒸汽祛水器(牙口手動式) CAST IRON STEAM TRAPS(SCREWED END HAND OPERATED)	25
● PN 4.0 Mpa 法蘭閘閥(Z40型) GATE VALVE PN 4.0 Mpa FLANGE END	8	● 鑄鐵蒸汽祛水器(牙口自動式) CAST IRON STEAM TRAPS(SCREWED END AUTOMATIC TYPE)	25
● PN 1.6 Mpa 法蘭止回閥(H44型) SWING CHECK VALVE PN 1.6 Mpa FLANGE END	9	● 鑄鐵倒筒式蒸汽祛水器 CAST IRON INVERTED BUCKET TYPE STEAM TRAPS	26
● PN 4.0 Mpa 法蘭止回閥(H44型) SWING CHECK VALVE PN 4.0 Mpa FLANGE END	9	● 鑄鐵倒筒式蒸汽祛水器 CAST IRON INVERTED BUCKET TYPE STEAM TRAPS	27
● 波紋管法蘭截止閥 BELLOWS TYPE GLOBE VALVE DIN-PN16/PN25/PN40 FLANGE END	10	● 全不銹鋼倒筒式蒸汽祛水器 ALL STAINLESS STEEL INVERTED BUCKET TYPE STEAM TRAPS	28
● 波紋管法蘭截止閥 BELLOWS TYPE GLOBE VALVE ANSI 150LB FLANGE END	11	● 全不銹鋼倒筒式蒸汽祛水器 ALL STAINLESS STEEL INVERTED BUCKET TYPE STEAM TRAPS	29
● 齒輪箱操作器 WORM GEAR OPERATOR	12	● 鍛鋼倒筒式蒸汽祛水器 FORGED STEEL INVERTED BUCKET TYPE STEAM TRAPS	30
● 對夾式不銹鋼蝶閥(齒輪式操作) WAFER TYPE BUTTERFLY VALVE(WORM GEAR OPERATION)	13	● 鍛鋼倒筒式蒸汽祛水器 FORGED STEEL INVERTED BUCKET TYPE STEAM TRAPS	31
● 對夾式不銹鋼蝶閥(手柄式操作) WAFER TYPE BUTTERFLY VALVE(LEVER OPERATION)	14	● 倒筒式蒸汽祛水器連續排水量表 IB STEAM TRAPS CAPACITY CHART	32
● 對夾式蝶閥(齒輪式操作) WAFER TYPE BUTTERFLY VALVE(WORM GEAR OPERATION)	15	● 倒筒式蒸汽祛水器連續排水量表使用說明 IB STEAM TRAPS CAPACITY CHART INSTRUCTIONS	33
● 對夾式蝶閥(手柄式操作) WAFER TYPE BUTTERFLY VALVE(LEVER OPERATION)	16	● 鑄鋼倒筒式蒸汽祛水器 CAST STEEL INVERTED BUCKET TYPE STEAM TRAPS	34

800LB 鍛鋼閘閥

800LB FORGED STEEL GATE VALVE



牙口端 SCREWED END
 TC-353S A182 F22-ANSI-800LB
 TC-354S A105N-ANSI-800LB
 TC-355S A182 F304-ANSI-800LB
 TC-356S A182 F316-ANSI-800LB

套焊口端 SOCKET WELD END
 TC-353SW A182 F22-ANSI-800LB
 TC-354SW A105N-ANSI-800LB
 TC-355SW A182 F304-ANSI-800LB
 TC-356SW A182 F316-ANSI-800LB

壓力測試 TEST PRESSURE:

公稱壓力	Nominal pressure	800	CL
強度試驗	Strength testing pressure	21	MPa
上密封試驗	Back seal test	15.6	MPa
密封試驗	Seal test	15.6	MPa
氣密封試驗	Steam seal test	0.6	MPa
最高工作溫度	Max. working temperature	425	°C
適用介質	Applicable	W.O.G. etc	

尺寸表 DIMENSIONS:

SIZE	d	L	H	W	T
1/2"	21.9	79	160	90	9.6
3/4"	27.2	92	165	90	12.7
1"	33.9	111	195	115	12.7
1 1/4"	42.7	120	242	145	12.7
1 1/2"	48.8	120	252	145	12.7
2"	61.2	140	290	170	15.7

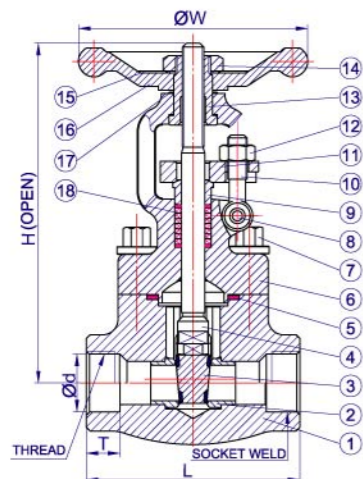

材質表 MATERIALS LIST:

NO.	名稱	PART NAME	CS to ASTM	AS to ASTM	SS to ASTM	
			Type A 105N	Type F 22	Type F304(L)	Type F316(L)
1	閥體	BODY	A105N	A182 F22	A182 F304(L)	A182 F316(L)
2	閥座	STEM RING	A276 420	A276 304	A276 304(L)	A276 316(L)
3	閘板	WEDGE	A276/F430	A182 F304	A182 F304(L)	A182 F316(L)
4	閘杆	STEM	A182 F6	A182 F22	A182 F304(L)	A182 F316(L)
5	墊片	GASKET	304+GRAPHITE		316+GRAPHITE	
6	閘蓋	BONNET	A105	A182 F22	A182 F304(L)	A182 F316(L)
7	螺栓	BONNET BOLT	A193 B7	A193 B16	A193 B8	A193 B8M
8	圓柱銷	PIN	A276 420		A182 F304	
9	填料壓套	GLAND	A276 420		A182 F304(L)	A182 F316(L)
10	活節螺栓	GLAND EYEBOLT	A193 B7	A193 B16	A193 B8	A193 B8M
11	填料壓板	GLAND FLANGE	A105	A182 F11	A182 F304(L)	A182 F316(L)
12	壓板螺母	GLAND NUT	A194 2H	A194 4	A194 8	A194 8M
13	閘杆螺母	YOKE NUT	A276 420			
14	鎖緊螺母	H.W.LOCK NUT	A194 2H	A194 4	A194 8	A194 8M
15	銘牌	NAMEPLATE	SS304			
16	手輪	HANDLEWHEEL	A197			
17	潤滑墊片	BEARING GASKET	A473 431			
18	填料	STEM PACKING	EXPANDED GRAPHITE			

800LB 鍛鋼截止閥

800LB FORGED STEEL GLOBE VALVE



牙口端 SCREWED END
 TC-453S A182 F22-ANSI-800LB
 TC-454S A105N-ANSI-800LB
 TC-455S A182 F304-ANSI-800LB
 TC-456S A182 F316-ANSI-800LB

套焊口端 SOCKET WELD END
 TC-453SW A182 F22-ANSI-800LB
 TC-454SW A105N-ANSI-800LB
 TC-455SW A182 F304-ANSI-800LB
 TC-456SW A182 F316-ANSI-800LB

壓力測試 TEST PRESSURE:

公稱壓力	Nominal pressure	800	CL
強度試驗	Strength testing pressure	21	MPa
上密封試驗	Back seal test	15.6	MPa
密封試驗	Seal test	15.6	MPa
氣密封試驗	Steam seal test	0.6	MPa
最高工作溫度	Max. working temperature	425	°C
適用介質	Applicable	W.O.G. etc	

尺寸表 DIMENSIONS:

SIZE	d	L	H	W	T
1/2"	21.9	79	160	90	9.6
3/4"	27.2	92	161	90	12.7
1"	33.9	111	200	115	12.7
1 1/4"	42.7	120	234	145	12.7
1 1/2"	48.8	152	246	145	12.7
2"	61.1	172	285	170	15.7

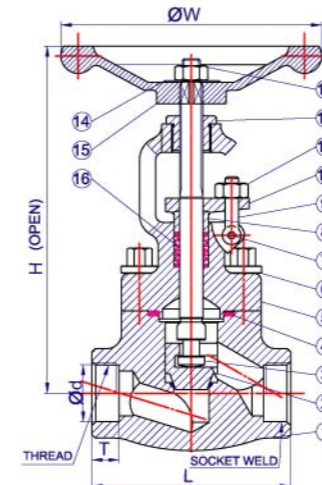

材質表 MATERIALS LIST:

NO.	名稱	PART NAME	CS to ASTM	AS to ASTM	SS to ASTM	
			Type A 105N	Type F 22	Type F304(L)	Type F316(L)
1	閥體	BODY	A105N	A182 F22	A182 F304(L)	A182 F316(L)
2	閥瓣	DISC	A276 420	A276 F22	A276 304(L)	A276 316(L)
3	閘杆	STEM	A182 F6a	A182	A182 F304(L)	A182 F316(L)
4	墊片	GASKET	304+GRAPHITE		316+GRAPHITE	
5	閘蓋	BONNET	A105N	A182 F22	A182 F304(L)	A182 F316(L)
6	螺栓	BONNET BOLT	A193 B7	A193 B16	A193 B8	A193 B8M
7	圓柱銷	PIN	A276 420		A276 F304	
8	填料壓套	GLAND	A276 420		A182 F316(L)	
9	活節螺栓	GLAND EYEBOLT	A193 B7	A193 B6	A193 B8	A193 B8M
10	填料壓板	GLAND FLANGE	A105		A182 F304	
11	壓板螺母	GLAND NUT	A194 2H	A194 4	A194 8	A194 8M
12	閘杆螺母	YOKE NUT	A276 420			
13	鎖緊螺母	H.W.LOCK NUT	A194 2H	A194 4	A194 8	A194 8M
14	銘牌	NAMEPLATE	SS304			
15	手輪	HANDLEWHEEL	A197			
16	填料	STEM PACKING	EXPANDED GRAPHITE			

800LB 鍛鋼旋啟式止回閥

800LB FORGED STEEL SWING CHECK VALVE

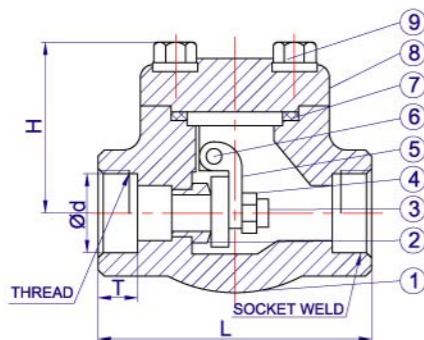

材質表 MATERIALS LIST:

NO.	名稱	PART NAME	CS to ASTM	AS to ASTM	SS to ASTM	
			Type A 105N	Type F 22	Type F304(L)	Type F316(L)
1	閥體	BODY	A105N	A182 F22	A182 F304(L)	A182 F316(L)
2	閥座	STEM RING	A276 420	A276 304	A276 304(L)	A276 316(L)
3	閥瓣	DISC	A276 420	A276 F22	A276 304(L)	A276 316(L)
4	螺母	NUT	A194 2H	A194 4	A194 8	A194 8M
5	搖臂	HINGE	A182 304 (L)		A182 F316(L)	
6	圓柱銷	PIN	A276 420		A182 F304(L) A182 F316(L)	
7	墊片	GASKET	304+GRAPHITE		316+GRAPHITE	
8	閥蓋	BONNET	A105N	A182 F22	A182 F304(L)	A182 F316(L)
9	螺栓	BONNET BOLT	A193 B7	A193 B16	A193 B8(M)	A193 B8M

800LB 鍛鋼升降式止回閥

800LB FORGED STEEL PISTON CHECK VALVE

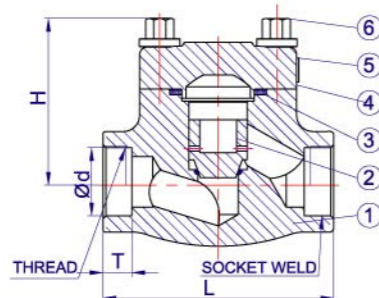

材質表 MATERIALS LIST:

NO.	名稱	PART NAME	CS to ASTM	AS to ASTM	SS to ASTM	
			Type A 105N	Type F 22	Type F304(L)	Type F316(L)
1	閥體	BODY	A105N	A182 F22	A182 F304(L)	A182 F316(L)
2	閥瓣	DISC	A276 420	A276 304	A276 304(L)	A276 316(L)
3	墊片	GASKET	304+GRAPHITE		316+GRAPHITE	
4	閥蓋	BONNET	A105N	A182 F22	A182 F304(L)	A182 F316(L)
5	銘牌	NAMEPLATE	SS304			
6	螺栓	BONNET BOLT	A193 B7	A193 B16	A193 B8(M)	A193 B8M

牙口端 SCREWED END
TC-553S A182 F22-ANSI-800LB
TC-554S A105N-ANSI-800LB
TC-555S A182 F304-ANSI-800LB
TC-556S A182 F316-ANSI-800LB

套焊口端 SOCKET WELD END
TC-553SW A182 F22-ANSI-800LB
TC-554SW A105N-ANSI-800LB
TC-555SW A182 F304-ANSI-800LB
TC-556SW A182 F316-ANSI-800LB

壓力測試 TEST PRESSURE:

公稱壓力	Nominal pressure	800	CL
強度試驗	Strength testing pressure	21	MPa
上密封試驗	Back seal test	15.6	MPa
密封試驗	Seal test	15.6	MPa
氣密封試驗	Steam seal test	0.6	MPa
最高工作溫度	Max. working temperature	425	°C
適用介質	Applicable	W.O.G.etc	

尺寸表 DIMENSIONS:

SIZE	d	L	H	T
1/2"	21.9	79	55	9.6
3/4"	27.2	92	58	12.7
1"	33.9	111	72	12.7
1 1/4"	42.7	120	85	12.7
1 1/2"	48.8	120	100	12.7
2"	61.1	140	108	15.7

牙口端 SCREWED END
TC-553PS A182 F22-ANSI-800LB
TC-554PS A105N-ANSI-800LB
TC-555PS A182 F304-ANSI-800LB
TC-556PS A182 F316-ANSI-800LB

套焊口端 SOCKET WELD END
TC-553PSW A182 F22-ANSI-800LB
TC-554PSW A105N-ANSI-800LB
TC-555PSW A182 F304-ANSI-800LB
TC-556PSW A182 F316-ANSI-800LB

壓力測試 TEST PRESSURE:

公稱壓力	Nominal pressure	800	CL
強度試驗	Strength testing pressure	21	MPa
上密封試驗	Back seal test	15.6	MPa
密封試驗	Seal test	15.6	MPa
氣密封試驗	Steam seal test	0.6	MPa
最高工作溫度	Max. working temperature	425	°C
適用介質	Applicable	W.O.G.etc	

尺寸表 DIMENSIONS:

SIZE	d	L	H	T
1/2"	21.9	79	55	9.6
3/4"	27.2	92	58	12.7
1"	33.9	111	72	12.7
1 1/4"	42.7	120	85	12.7
1 1/2"	48.8	152	100	12.7
2"	61.1	172	108	15.7

PN 1.6 Mpa 法蘭閘閥(Z41型)

GATE VALVE PN 1.6 Mpa FLANGE END

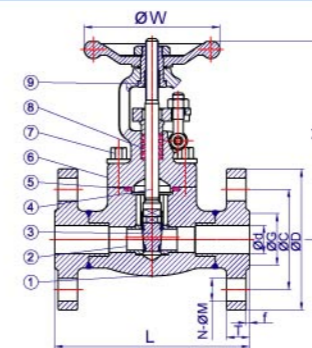

特徵 FEATURES:

結構長度 FACE TO FACE DIMENSION: GB/T 12221
法蘭標準 END FLANGE DIMENSION: GB/T 9113
設計與鑄造標準 BASIC DESIGN: GB/T12235
測試標準 TEST: API 598

PN 1.6 Mpa 法蘭截止閥(J41型)

GLOBE VALVE PN 1.6 Mpa FLANGE END

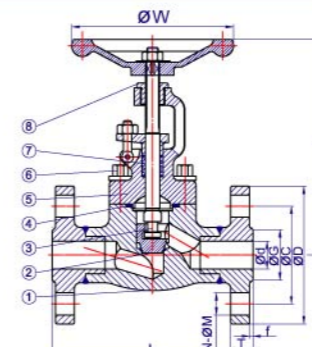

特徵 FEATURES:

結構長度 FACE TO FACE DIMENSION: GB/T 12221
法蘭標準 END FLANGE DIMENSION: GB/T 9113
設計與鑄造標準 BASIC DESIGN: GB/T12235
測試標準 TEST: API 598

PN 1.6 Mpa 法蘭止回閥(H44型)

SWING CHECK VALVE PN 1.6 Mpa FLANGE END

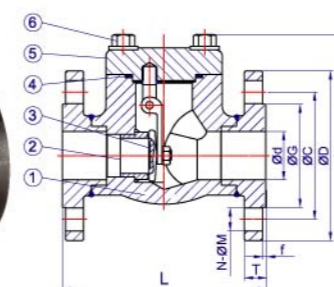

特徵 FEATURES:

結構長度 FACE TO FACE DIMENSION: GB/T 12221
法蘭標準 END FLANGE DIMENSION: GB/T 9113
設計與鑄造標準 BASIC DESIGN: GB/T12235
測試標準 TEST: API 598

材質表 MATERIALS LIST:

NO.	名稱	PART NAME	材料 MATERIAL
1	閥體	BODY	A105
2	閥座	STEM RING	13Cr
3	閥瓣	DISC	13Cr
4	閥杆	STEM	13Cr
5	墊片	GASKET	304+GRAPHITE
6	閥蓋	BONNET	A105
7	螺栓	BONNET BOLT	A193 B7
8	填料	STEM PACKING	EXPANDED GRAPHITE
9	閥杆螺母	YOKE NUT	A276 420

尺寸表 DIMENSIONS:

SIZE	d	L	H	W	D	C	G	f	T	N-ØM
15	15	130	160	90	95	65	46	2	14	4-Ø14
20	20	150	165	90	105	75	56	2	16	4-Ø14
25	25	160	195	115	115	85	65	3	16	4-Ø14
32	32	180	242	145	140	100	76	3	18	4-Ø18
40	40	240	252	145	150	110	84	3	18	4-Ø18
50	50	250	290	170	165	125	99	3	20	4-Ø18

材質表 MATERIALS LIST:

NO.	名稱	PART NAME	材料 MATERIAL
1	閥體	BODY	A105
2	閥瓣	DISC	13Cr
3	閥杆	STEM	13Cr
4	墊片	GASKET	304+GRAPHITE
5	閥蓋	BONNET	A105
6	螺栓	BONNET BOLT	A193 B7
7	填料	STEM PACKING	EXPANDED GRAPHITE
8	閥杆螺母	YOKE NUT	A276 420

尺寸表 DIMENSIONS:

SIZE	d	L	H	W	D	C	G	f	T	N-ØM
15	15	130	160	90	95	65	46	2	14	4-Ø14
20	20	150	161	90	105	75	56	2	16	4-Ø14
25	25	160	200	115	115	85	65	3	16	4-Ø14
32	32	190	234	145	140	100	76	3	18	4-Ø18
40	40	200	246	145	150	110	84	3	18	4-Ø18
50	50	230	285	170	165	125	99	3	20	4-Ø18

材質表 MATERIALS LIST:

NO.	名稱	PART NAME	材料 MATERIAL
1	閥體	BODY	A105
2	閥座	STEM RING	13Cr
3	閥瓣	DISC	13Cr
4	墊片	GASKET	304+GRAPHITE
5	閥蓋	BONNET	A105
6	螺栓	BONNET BOLT	A193 B7

尺寸表 DIMENSIONS:

SIZE	d	L	H	D	C	G	f	T	N-ØM
15	15	130	55	95	65	46	2	14	4-Ø14
20	20	150	58	105	75	56	2	16	4-Ø14
25	25	160	72	115	85	65	3	16	4-Ø14
32	32	190	85	140	100	76	3	18	4-Ø18
40	40	200	100	150	110	84	3	18	4-Ø18
50	50	230	108	165	125	99	3	20	4-Ø18

PN 1.6 Mpa法蘭截止閥(J41型)

GLOBE VALVE PN 1.6 Mpa FLANGE END

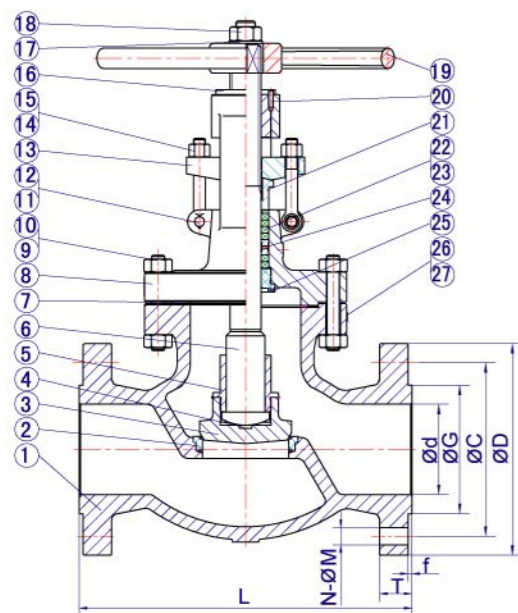

特徵 FEATURES:

結構長度 FACE TO FACE DIMENSION: GB/T 12221
 法蘭標準 END FLANGE DIMENSION: GB/T 9113
 設計與鑄造標準 BASIC DESIGN: GB/T 12224
 測試標準 TEST: API 598

材質表 MATERIALS LIST:

NO.	名稱	PART NAME	材料 MATERIAL
1	閥體	BODY	WCB
2	閥座	SEAT	A105+HF
3	閥瓣	DISC	WCB+F6
4	止推墊	THRUST PLATE	A276 430
5	閥瓣蓋	DISC COVER	A276 410
6	閥杆	STEM	A182 F6
7	墊片	GASKET	304+FLexible Graphite
8	閥蓋	BONNET	WCB
9	螺栓	BOLT	A193 B7
10	螺母	NUT	A194 2H
11	銷軸	PIN	A29 1035
12	開口銷	SPLIT PIN	A570 Gr.A
13	壓板	GLAND FLANGE	WCB
14	螺栓	EYE BOLT	A193 B7
15	螺母	EYE NUT	A194 2H
16	閥母	STEM NUT	BRASS
17	墊片	GASKET	A276 410
18	螺母	NUT	A29 1035
19	手輪	HANDLEWHEEL	60-40-18
20	螺釘	SCREW	A29 1035
21	壓套	GLAND	A276 410
22	填料	PACKING	Graphite
23	填料	PACKING	
24	隔環	DISTANCE RING	A276 410
25	密封座	BACK SEAT	A276 410
26	鉚釘	RIVET	304
27	銘牌	NAMEPLATE	304

尺寸表 DIMENSIONS:

SIZE	d	L	D	C	G	f	T	N-ØM	
2"	50	50	230	165	125	99	3	20	4-Ø18
2 1/2"	65	65	290	185	145	118	3	20	4-Ø18
3"	80	80	310	200	160	132	3	20	8-Ø18
4"	100	100	350	220	180	156	3	22	8-Ø18
5"	125	125	400	250	210	184	3	22	8-Ø18
6"	150	150	480	285	240	211	3	24	8-Ø22
8"	200	200	600	340	295	266	3	24	12-Ø22
10"	250	250	730	405	355	319	3	26	12-Ø26
12"	300	300	850	460	410	370	4	28	12-Ø26

PN 4.0 Mpa法蘭截止閥(J41型)

GLOBE VALVE PN 4.0 Mpa FLANGE END

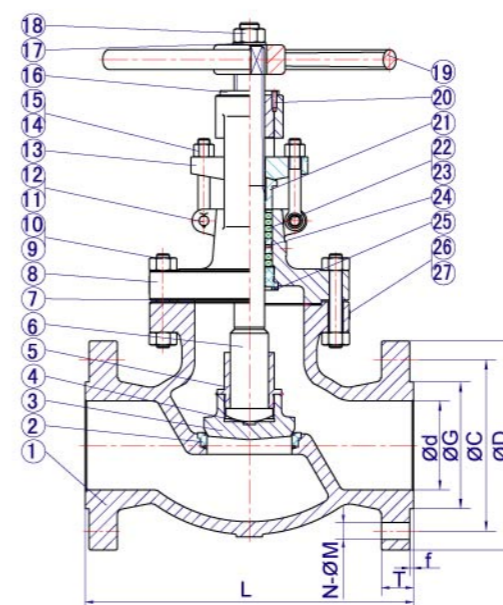
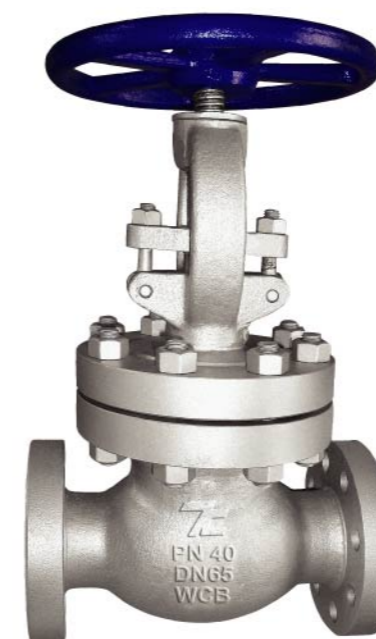

特徵 FEATURES:

結構長度 FACE TO FACE DIMENSION: GB/T 12221
 法蘭標準 END FLANGE DIMENSION: GB/T 9113
 設計與鑄造標準 BASIC DESIGN: GB/T 12224
 測試標準 EST: API 598

材質表 MATERIALS LIST:

NO.	名稱	PART NAME	材料 MATERIAL
1	閥體	BODY	WCB
2	閥座	SEAT	A105+HF
3	閥瓣	DISC	WCB+F6
4	止推墊	THRUST PLATE	A276 430
5	閥瓣蓋	DISC COVER	A276 410
6	閥杆	STEM	A182 F6
7	墊片	GASKET	304+FLexible Graphite
8	閥蓋	BONNET	WCB
9	螺栓	BOLT	A193 B7
10	螺母	NUT	A194 2H
11	銷軸	PIN	A29 1035
12	開口銷	SPLIT PIN	A570 Gr.A
13	壓板	GLAND FLANGE	WCB
14	螺栓	EYE BOLT	A193 B7
15	螺母	EYE NUT	A194 2H
16	閥母	STEM NUT	BRASS
17	墊片	GASKET	A276 410
18	螺母	NUT	A29 1035
19	手輪	HANDLEWHEEL	60-40-18
20	螺釘	SCREW	A29 1035
21	壓套	GLAND	A276 410
22	填料	PACKING	Graphite
23	填料	PACKING	
24	隔環	DISTANCE RING	A276 410
25	密封座	BACK SEAT	A276 410
26	鉚釘	RIVET	304
27	銘牌	NAMEPLATE	304

尺寸表 DIMENSIONS:

SIZE	d	L	D	C	G	f	T	N-ØM	
2"	50	50	230	165	125	99	3	20	4-Ø18
2 1/2"	65	65	290	185	145	118	3	22	8-Ø18
3"	80	80	310	200	160	132	3	24	8-Ø18
4"	100	100	350	235	190	156	3	24	8-Ø22
5"	125	125	400	270	220	184	3	26	8-Ø26
6"	150	150	480	300	250	211	3	28	8-Ø26

PN 1.6 Mpa法蘭閘閥(Z40型)

GATE VALVE PN 1.6 Mpa FLANGE END

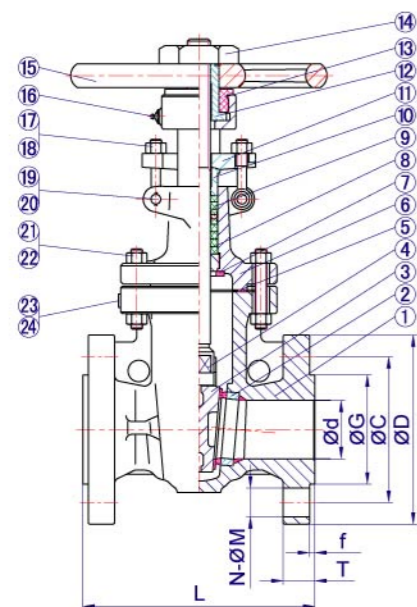

特徵 FEATURES:

結構長度 FACE TO FACE DIMENSION: GB/T 12221
 法蘭標準 END FLANGE DIMENSION: GB/T 9113
 設計與鑄造標準 BASIC DESIGN: GB/T 12224
 測試標準 TEST: API 598

材質表 MATERIALS LIST:

NO.	名稱	PART NAME	材料 MATERIAL
1	閥體	BODY	WCB
2	閥座	SEAT	A105+HF
3	閘板	WEDGE	WCB+F6
4	閥杆	STEM	A182 F6
5	墊片	GASKET	08F+Flexible Graphite
6	閥蓋	BONNET	WCB
7	密封座	BACK SEAT	A276 410
8	填料	PACKING	Stainless Steel Wire With Flexible Grphite
9	填料	PACKING	Flexible Grphite
10	壓套	GLAND	A276 410
11	壓板	GLAND FLANGE	WCB
12	閥母	STEM NUT	BRASS
13	鎖母	LOCK NUT	1035
14	壓母	GLAND NUT	A29 1035
15	手輪	HANDLEWHEEL	60-40-18
16	油杯	OILFILLER	A570 Gr.A
17	螺栓	EYE BOLT	A193 B7
18	螺母	EYE NUT	A194 2H
19	銷軸	PIN	A29 1035
20	開口銷	SPLIT PIN	A570 Gr.A
21	螺柱	BOLT	A193 B7
22	螺母	NUT	A194 2H
23	鉚釘	RIVET	304
24	銘牌	NAMEPLATE	304

尺寸表 DIMENSIONS:

SIZE	d	L	D	C	G	f	T	N-ØM	
2"	50	50	250	165	125	99	3	20	4-Ø18
2 1/2"	65	65	270	185	145	118	3	20	4-Ø18
3"	80	80	280	200	160	132	3	20	8-Ø18
4"	100	100	300	220	180	156	3	22	8-Ø18
5"	125	125	325	250	210	184	3	22	8-Ø18
6"	150	150	350	285	240	211	3	24	8-Ø22
8"	200	200	400	340	295	266	3	24	12-Ø22
10"	250	250	450	405	355	319	3	26	12-Ø26
12"	300	300	500	460	410	370	4	28	12-Ø26

PN 4.0 Mpa法蘭閘閥(Z40型)

GATE VALVE PN 4.0 Mpa FLANGE END

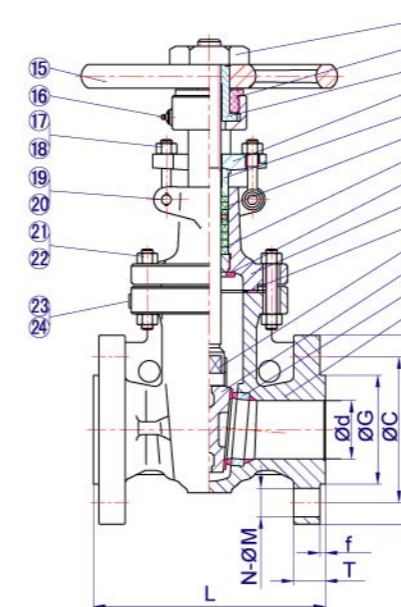
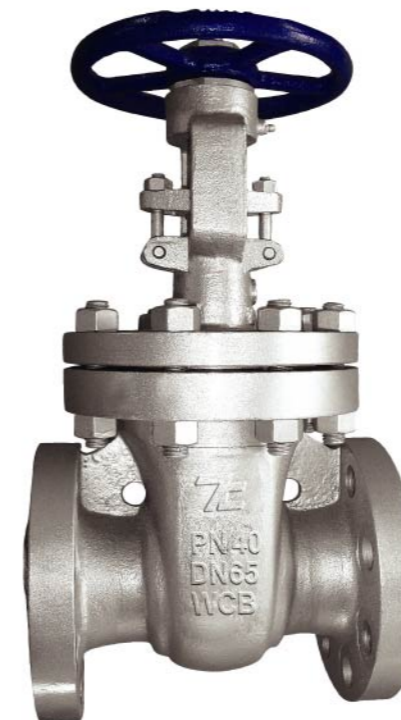

特徵 FEATURES:

結構長度 FACE TO FACE DIMENSION: GB/T 12221
 法蘭標準 END FLANGE DIMENSION: GB/T 9113
 設計與鑄造標準 BASIC DESIGN: GB/T 12224
 測試標準 TEST: API 598

材質表 MATERIALS LIST:

NO.	名稱	PART NAME	材料 MATERIAL
1	閥體	BODY	WCB
2	閥座	SEAT	A105+HF
3	閘板	WEDGE	WCB+F6
4	閥杆	STEM	A182 F6
5	墊片	GASKET	08F+Flexible Graphite
6	閥蓋	BONNET	WCB
7	密封座	BACK SEAT	A276 410
8	填料	PACKING	Stainless Steel Wire With Flexible Grphite
9	填料	PACKING	Flexible Grphite
10	壓套	GLAND	A276 410
11	壓板	GLAND FLANGE	WCB
12	閥母	STEM NUT	BRASS
13	鎖母	LOCK NUT	1035
14	壓母	GLAND NUT	A29 1035
15	手輪	HANDLEWHEEL	60-40-18
16	油杯	OILFILLER	A570 Gr.A
17	螺栓	EYE BOLT	A193 B7
18	螺母	EYE NUT	A194 2H
19	銷軸	PIN	A29 1035
20	開口銷	SPLIT PIN	A570 Gr.A
21	螺柱	BOLT	A193 B7
22	螺母	NUT	A194 2H
23	鉚釘	RIVET	304
24	銘牌	NAMEPLATE	304

尺寸表 DIMENSIONS:

SIZE	d	L	D	C	G	f	T	N-ØM	
2"	50	50	250	165	125	99	3	20	4-Ø18
2 1/2"	65	65	290	185	145	118	3	22	8-Ø18
3"	80	80	310	200	160	132	3	24	8-Ø18
4"	100	100	350	235	190	156	3	24	8-Ø22
5"	125	125	400	270	220	184	3	26	8-Ø26
6"	150	150	450	300	250	211	3	28	8-Ø26

PN 1.6 Mpa法蘭止回閥(H44型)

SWING CHECK VALVE PN 1.6 Mpa FLANGE END

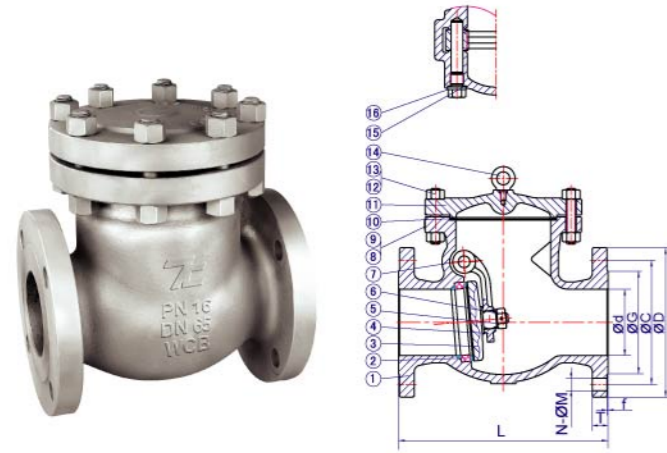

特徵 FEATURES:

結構長度 FACE TO FACE DIMENSIONS: GB/T 12221
 法蘭標準 END FLANGE DIMENSION: GB/T 9113
 設計與製造標準 BASIC DESIGN: GB/T 12224
 測試標準 TEST: API 598

材質表 MATERIALS LIST:

NO.	名稱	PART NAME	材料 MATERIAL
1	閥體	BODY	WCB
2	閥座	SEAT	A105+HF
3	閥瓣	DISC	WCB+F6
4	搖杆	HINGE	WCB
5	墊片	GASKET	A276 410
6	螺母	NUT	A276 410
7	銷軸	PIN	A276 410
8	鉚釘	RIVET	304
9	銘牌	NAMEPLATE	304
10	墊片	GASKET	304+Flexible Graphite
11	閥蓋	BONNET	WCB
12	螺柱	BOLT	A193 B7
13	螺母	NUT	A194 2h
14	吊環	EYEBOLT	A29 1035
15	墊片	GASKET	1008
16	螺塞	PLUG	A276 410

尺寸表 DIMENSIONS:

SIZE	d	L	D	C	G	f	T	N-ØM	
2"	50	50	230	165	125	99	3	20	4-Ø18
2 1/2"	65	65	290	185	145	118	3	20	4-Ø18
3"	80	80	310	200	160	132	3	20	8-Ø18
4"	100	100	350	220	180	156	3	22	8-Ø18
5"	125	125	400	250	210	184	3	22	8-Ø18
6"	150	150	480	285	240	211	3	24	8-Ø22
8"	200	200	495	340	295	266	3	24	12-Ø22
10"	250	250	730	405	355	319	3	26	12-Ø26
12"	300	300	850	460	410	370	4	28	12-Ø26

PN 4.0 Mpa法蘭止回閥(H44型)

SWING CHECK VALVE PN 4.0 Mpa FLANGE END

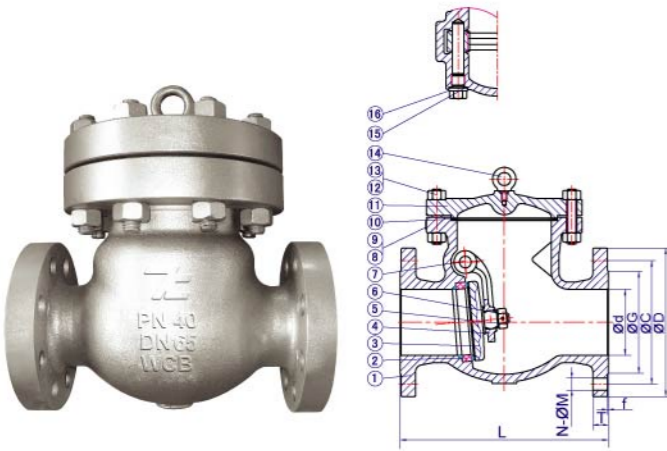

特徵 FEATURES:

結構長度 FACE TO FACE DIMENSIONS: GB/T 12221
 法蘭標準 END FLANGE DIMENSION: GB/T 9113
 設計與製造標準 BASIC DESIGN: GB/T 12224
 測試標準 TEST: API 598

材質表 MATERIALS LIST:

NO.	名稱	PART NAME	材料 MATERIAL
1	閥體	BODY	WCB
2	閥座	SEAT	A105+HF
3	閥瓣	DISC	WCB+F6
4	搖杆	HINGE	WCB
5	墊片	GASKET	A276 410
6	螺母	NUT	A276 410
7	銷軸	PIN	A276 410
8	鉚釘	RIVET	304
9	銘牌	NAMEPLATE	304
10	墊片	GASKET	304+Flexible Graphite
11	閥蓋	BONNET	WCB
12	螺柱	BOLT	A193 B7
13	螺母	NUT	A194 2h
14	吊環	EYEBOLT	A29 1035
15	墊片	GASKET	1008
16	螺塞	PLUG	A276 410

尺寸表 DIMENSIONS:

SIZE	d	L	D	C	G	f	T	N-ØM	
2"	50	50	230	165	125	99	3	20	4-Ø18
2 1/2"	65	65	290	185	145	118	3	22	8-Ø18
3"	80	80	310	200	160	132	3	24	8-Ø18
4"	100	100	350	235	190	156	3	24	8-Ø22
5"	125	125	400	270	220	184	3	26	8-Ø26
6"	150	150	480	300	250	211	3	28	8-Ø26

波紋管法蘭截止閥

BELLOWS TYPE GLOBE VALVE DIN-PN16/PN25/PN40 FLANGE END



特徵 FEATURES:

設計與製造標準 BASIC DESIGN: EN13709;
 結構長度 FACE TO FACE DIMENSION: EN558;
 法蘭標準 END FLANGE DIMENSION: EN1092;
 測試標準 TEST: EN12266.

壓力測試 TEST PRESSURE:

等級	CLASS	1.6MPa	2.5MPa	4.0MPa
殼體測試	SHELL TEST	2.4MPa	3.8MPa	6.0MPa
密封測試(水壓)	SEAL TEST (WATER)	1.8MPa	2.8MPa	4.4MPa
密封測試(氣壓)	SEAL TEST (AIR)	0.6MPa		
適合溫度範圍	SUITABLE TEM.	-20~350°C		
適用介質	SUITABLE MEDIUM	W.O.G		

材質表 MATERIALS LIST:

NO.	部件名稱	PART NAME	材料 MATERIAL
1	閥體	BODY	1.0619+13Cr
2	閥瓣	DISC	C.S+13Cr
3	定位銷	PIN	SS304
4	波紋管	BELLOWS	SS304
5	大薄片	GASKET	SS304+GRAPHITE
6	螺柱	BOLT	B7
7	螺母	NUT	2H
8	閥蓋	BONNET	1.0619
9	中口	PACKING	GRAPHITE
10	套筒	GLAND	13Cr
11	定位銷	PIN	25
12	導向片	GUIDE PIECE	C.S
13	軸心	STEM	1Cr13
14	軸套螺母	YOKE NUT	CU ALLOY
15	手輪	HANDLEWHEEL	C.S
16	螺母	NUT	AL AL LOY

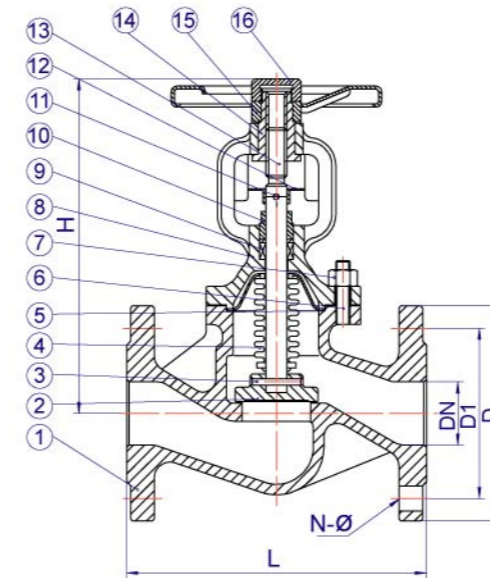

尺寸表 DIMENSIONS:

DN	PN16					PN25					PN40				
	L	D	D1	N-Ø	H	L	D	D1	N-Ø	H	L	D	D1	N-Ø	H
15	130	95	65	4×14	174	130	95	65	4×14	174	130	95	65	4×14	174
20	150	105	75	4×14	176	150	105	75	4×14	176	150	105	75	4×14	176
25	160	115	85	4×14	207	160	115	85	4×14	207	160	115	85	4×14	207
32	180	140	100	4×18	207	180	140	100	4×18	207	180	140	100	4×18	207
40	200	150	110	4×18	210	200	150	110	4×18	210	200	150	110	4×18	210
50	230	165	125	4×18	225	230	165	125	4×18	225	230	165	125	4×18	225
65	290	185	145	4×18	250	290	185	145	8×18	250	290	185	145	8×18	250
80	310	200	160	8×18	260	310	200	160	8×18	260	310	200	160	8×18	260
100	350	220	180	8×18	345	350	235	190	8×22	345	350	235	190	8×22	345
125	400	250	210	8×18	370	400	270	220	8×26	370	400	270	220	8×26	370
150	480	285	240	8×22	430	480	300	250	8×26	430	480	300	250	8×26	430
200	600	340	295	12×22	488	600	360	310	12×26	488	600	375	320	12×30	488

波紋管法蘭截止閥

BELLOWS TYPE GLOBE VALVE ANSI 150LB FLANGE END



特徵 FEATURES:

設計與製造標準 BASIC DESIGN: BS5160;
 結構長度 FACE TO FACE DIMENSION: ANSI B16.10;
 法蘭標準 END FLANGE DIMENSION: ANSI B16.5;
 測試標準 TEST: API598;
 波紋管 BELLOWS CONFORMS: MSS SP-177.

壓力測試 TEST PRESSURE:

正常壓力	NOMINAL PRESSURE	150LB
殼體測試	SHELL TEST	3.0MPa
密封測試(水壓)	SEAL TEST(WATER)	2.2MPa
密封測試(氣壓)	SEAL TEST (GAS)	0.6MPa
適合溫度範圍	SUITABLE TEM.	-20~350℃
適用介質	SUITABLE MEDIUM	W.O.G

材質表 MATERIALS LIST:

NO.	部件名稱	PART NAME	材料 MATERIAL
1	閥體	BODY	WCB+13Cr
2	閥瓣	DISC	WCB+13Cr
3	彈簧定位銷	SPRING PIN	1Cr18Ni9Ti
4	波紋管	BELLOWS	SS304
5	密封層	SEALING LAYER	SS304+FLEXIBLE GRAPHITE PACER
6	螺栓	BOLT	B7
7	螺母	NUT	2H
8	閥蓋	BONNET	WCB
9	中口	PACKING	FLEXIBLE GRAPHITE
10	軸帽	GLAND	Cr13
11	定位銷	PIN	1Cr18Ni9Ti
12	導向片	GUIDE PIECE	1Cr18Ni9Ti
13	軸心	STEM	13Cr
14	軸套螺母	YOKE NUT	Cu ALLOY
15	手輪	HANDLEWHEEL	C.S
16	螺母	LOCK NUT	Al ALLOY

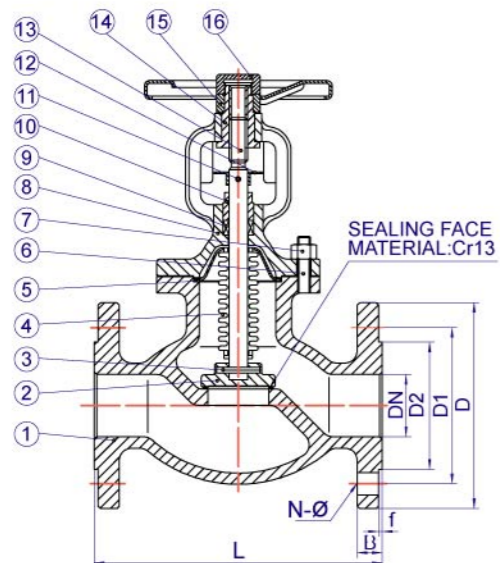

尺寸表 DIMENSIONS:

SIZE	DN(in)	L	D	D1	D2	B	f	N-Ø
1	2	203	152	120.5	92	16	1.6	4-19
2	2 1/2	216	178	139.5	105	18	1.6	4-19
3	3	241	190	152.5	127	19	1.6	4-19
4	4	292	229	190.5	157	24	1.6	8-19
5	5	356	254	216	186	24	1.6	8-22
6	6	406	279	241.5	216	26	1.6	8-22
7	8	495	343	298.5	270	29	1.6	8-22
8	10	622	406	362	324	31	1.6	12-25
9	12	698	483	432	381	32	1.6	12-25

齒輪箱操作器

WORM GEAR OPERATOR

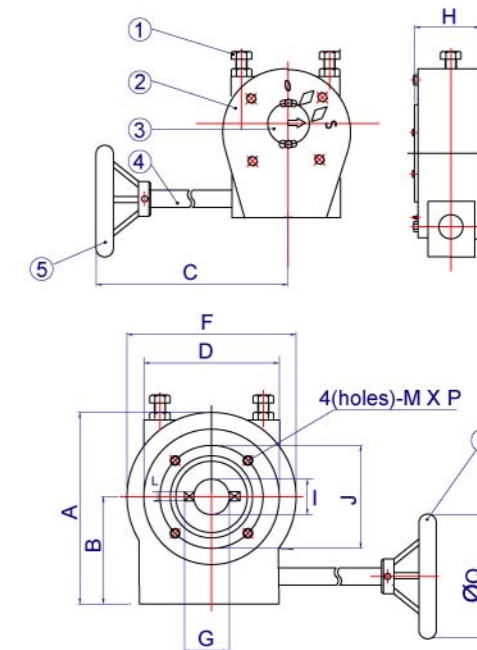
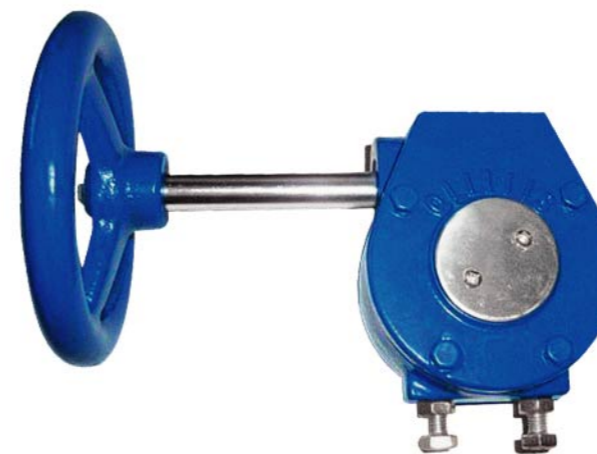

材質表 MATERIALS LIST:

ITEM	部件名稱	PART NAME	材料 MATERIAL		附註 REMARK
			JIS	ASTM	
1	調整螺絲	ADJUSTING SCREWS	S10C SUS304	AISI 1010 A351-CF8	— C.I S.S304
2	外殼	SHELL	FC200 SUS304	A126 CL-B A351-CF8	— S.S304
3	蝸輪	WORM GEAR	FCD450	A536	D.I
4	蝸桿	WORM SHAFT	S45C SUS304	AISI 1045 A351-CF8	— —
5	手輪	HANDLEWHEEL	FCD450 SUS304	A536 A351-CF8	— —

尺寸表 DIMENSIONS

機型 MODEL	扭力 TORQUE (N-M)	速比 RATIO	A	B	C	D	F	H	G	L	I	J	M	P	ØQ	附註 REMARK
WGO-1	200	24:1	125	70	155	90	100	55	21.5	5.00~5.40 x 1	19	70	8	12	150	Fit 2"~6"
WGO-2	600	30:1	170	95	220	120	150	75	25	6.00~6.40 x 1	22	102	10	15	270	Fit 8"~12"
WGO-3	1200	40:1	195	110	230	135	170	85	36	10.00~10.40 x 1	32	108	12	20	280	—
WGO-4	2400	50:1	250	145	260	198	210	95	39	10.00~10.40 x 1	35	160	16	25	320	Fit 14"~18"
WGO-5	4500	52:1	320	180	300	210	250	130	54	10.00~10.40 x 2	50	160	16	30	370	Fit 20"~24"

對夾式不鏽鋼蝶閥 (齒輪式操作)

WAFER TYPE BUTTERFLY VALVE
(WORM GEAR OPERATION)

特徵 FEATURES:

法蘭標準 END FLANGE DIMENSION: ANSI150LB;JIS10K;PN10;PN16;
結構長度 FACE TO FACE DIMENSION: ISO5752 SHORT BODY;
測試標準 TEST: API 598.

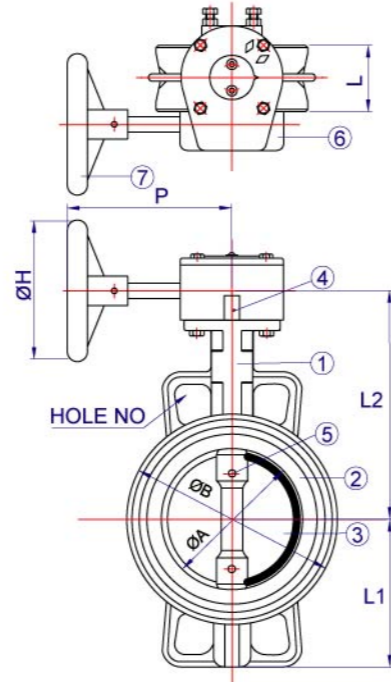

材質表 MATERIALS LIST:

NO.	部件名稱	PART NAME	材質	MATERIAL	DESCRIPTION	
					JIS	ASTM
1	閥體	BODY	不銹鋼	STAINLESS STEEL	SCS13,SCS14	A351,CF8,CF8M
					鑄鋼	CAST STEEL
2	閥座	SEAT	橡膠	RUBBER	BUNA-N(NBR)	
					EPDM	
3	閥瓣	DISC	鑄鋼	CAST STEEL	SCW42	A216 Gr. WCB
					SCS13, SCS14	A351 CF8,CF8M
4	閥杆	SHAFT	不銹鋼	STAINLESS STEEL	SUS410	A182 F410
					SUS316	A182 F316
					SUS304	A182 F304
5	定位銷	SET PIN	不銹鋼	STAINLESS STEEL	SCS13, SCS14	A182 F304 F316
6	蝸輪傳動箱	WORM GEAR BOX	鑄鐵	CAST IRON	FCD200, SCS13	A126CL-B, A351 CF8
					不銹鋼	STAINLESS STEEL
7	手輪	HANDLEWHEEL	球墨鑄鐵 不銹鋼	DUCTILE IRON STAINLESS STEEL	FCD200, SCS13	A126CL-B, A351 CF8

尺寸表 DIMENSIONS:

NO.	IN	2	2.5	3	4	5	6	8	10	12	14	16	18	20	24
		MM	50	65	80	100	125	150	200	250	300	350	400	450	500
閥門 VALVE	ØA	50	65	80	99	124	149	199	250	299	330	387	434	488	582
	ØB	100	117	132	153	189	217	263	328	379	410	480	525	585	693
	L1	66	75	80	109	124	138	173	205	243	268	307	335	381	457
	HOLE NO	2	2	2	4	4	4	4	4	4	4	4	4	4	4
	L	43	46	46	52	56	56	60	68	78	78	102	114	127	154
蝸輪 WORM GEAR	L2	148	149	161	176	192	233	278	331	379	497	436	460	514	600
	P	170	170	170	170	170	170	260	260	260	270	270	270	300	300
	ØH	160	160	160	160	160	160	250	250	250	325	325	325	385	385

對夾式不鏽鋼蝶閥 (手柄式操作)

WAFER TYPE BUTTERFLY VALVE
(LEVER OPERATION)

特徵 FEATURES:

法蘭標準 END FLANGE DIMENSION: ANSI150LB;JIS10K;PN10;PN16;
結構長度 FACE TO FACE DIMENSION: ISO5752 SHORT BODY;
測試標準 TEST: API 598.

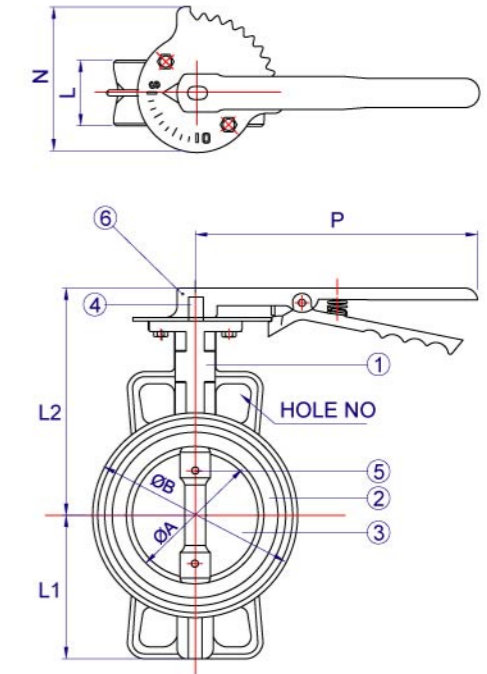

材質表 MATERIALS LIST:

NO.	部件名稱	PART NAME	材質	MATERIAL	DESCRIPTION	
					JIS	ASTM
1	閥體	BODY	不銹鋼	STAINLESS STEEL	SCS13,SCS14	A351,CF8,CF8M
					鑄鋼	CAST STEEL
2	閥座	SEAT	橡膠	RUBBER	BUNA-N(NBR)	
					EPDM	
3	閥瓣	DISC	鑄鋼	CAST STEEL	SCW42	A216 Gr. WCB
					SCS13, SCS14	A351 CF8,CF8M
4	閥杆	SHAFT	不銹鋼	STAINLESS STEEL	SUS410	A182 F410
					SUS316	A182 F316
					SUS304	A182 F304
5	定位銷	SET PIN	不銹鋼	STAINLESS STEEL	SCS13, SCS14	A182 F304 F316
6	手柄	LEVER HANDEL	球墨鑄鐵 不銹鋼	DUCTILE IRON STAINLESS STEEL	FCD450, SCS13	A536-65, A351 CF8

尺寸表 DIMENSIONS:

NO.	IN	2	2.5	3	4	5	6	8	10	12	14	16	18	20	24
		MM	50	65	80	100	125	150	200	250	300	350	400	450	500
閥門 VALVE	ØA	50	65	80	99	124	149	199	250	299	330	387	434	488	582
	ØB	100	117	132	153	189	217	263	328	379	410	480	525	585	693
	L1	66	75	80	109	124	138	173	205	243	268	307	335	381	457
	HOLE NO	2	2	2	4	4	4	4	4	4	4	4	4	4	4
	L	43	46	46	52	56	56	60	68	78	78	102	114	127	154
手柄 LEVER	L2	148	149	161	173	195	228	252	288	339	—	—	—	—	—
	P	170	170	170	250	250	250	410	410	410	—	—	—	—	—
	N	107	107	107	107	107	107	135	135	135	—	—	—	—	—

對夾式蝶閥 (齒輪式操作)

WAFER TYPE BUTTERFLY VALVE
(WORM GEAR OPERATION)



特徵 FEATURES:

法蘭標準 END FLANGE DIMENSION: ANSI150LB;JIS10K;PN10;PN16;
結構長度 FACE TO FACE DIMENSION: ISO5752 SHORT BODY;
測試標準 TEST: API 598.

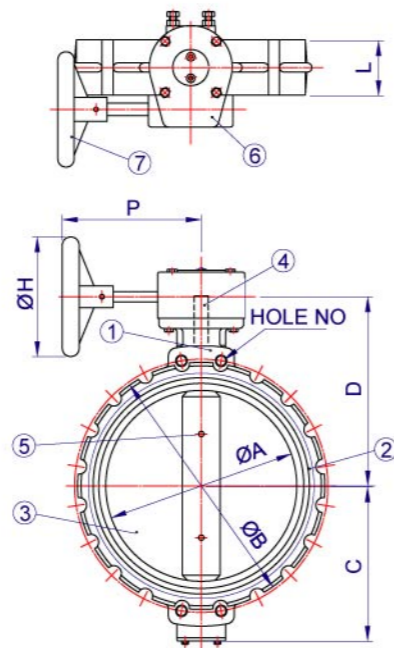

材質表 MATERIALS LIST:

NO.	部件名稱	PART NAME	材質	MATERIAL	DESCRIPTION	
					JIS	ASTM
1	閥體	BODY	鑄鐵	CAST IRON	FC200	A126 CLASS-B
			球墨鑄鐵	DUCTILE IRON	FCD450	A536-65-45-12
2	閥座	SEAT	橡膠	RUBBER	BUNA-N(NBR)	
					EPDM	
3	閥瓣	DISC	球墨鑄鐵	DUCTILE IRON	FCD450	A536-65-45-12
			不銹鋼	STAINLESS STEEL	SCS13	A351 CF8
4	閥杆	SHAFT	不銹鋼	STAINLESS STEEL	SUS410	A182 F410
					SUS316	A182 F316
					SUS304	A182 F304
					SCS13, SCS14	A182 F304 F316
5	定位銷	SET PIN	不銹鋼	STAINLESS STEEL	SCS13, SCS14	A182 F304 F316
6	蝸輪傳動箱	WORM GEAR BOX	鑄鐵	CAST IRON	FC200	A126 CLASS-B
7	手輪	HANDLEWHEEL	鑄鐵	CAST IRON	FC200	A126 CLASS-B

尺寸表 DIMENSIONS:

NO.	INCH	2	2.5	3	4	5	6	8	10	12	14	16	18	20	24
		MM	50	65	80	100	125	150	200	250	300	350	400	450	500
閥門 VALVE	ØA	50	65	80	99	124	149	199	250	299	328	380	431	489	582
	ØB	101	121	131	157	189	217	265	330	377	413	478	537	593	696
	C	64	78	81	104	120	138	175	204	236	268	307	335	381	457
	HOLE NO	2	2	2	2	2	2	4	4	4	4	4	4	8	8
	L	43	46	46	52	56	56	60	68	78	78	102	114	127	154
蝸輪 WORM GEAR	D	152	157	165	186	198	226	256	291	341	402	412	432	510	600
	P	170	170	170	170	170	170	260	260	260	270	270	270	300	300
	ØH	160	160	160	160	160	160	285	285	285	325	325	325	385	385

對夾式蝶閥 (手柄式操作)

WAFER TYPE BUTTERFLY VALVE
(LEVER OPERATION)



特徵 FEATURES:

法蘭標準 END FLANGE DIMENSION: ANSI150LB;JIS10K;PN10;PN16;
結構長度 FACE TO FACE DIMENSION: ISO5752 SHORT BODY;
測試標準 TEST: API 598.

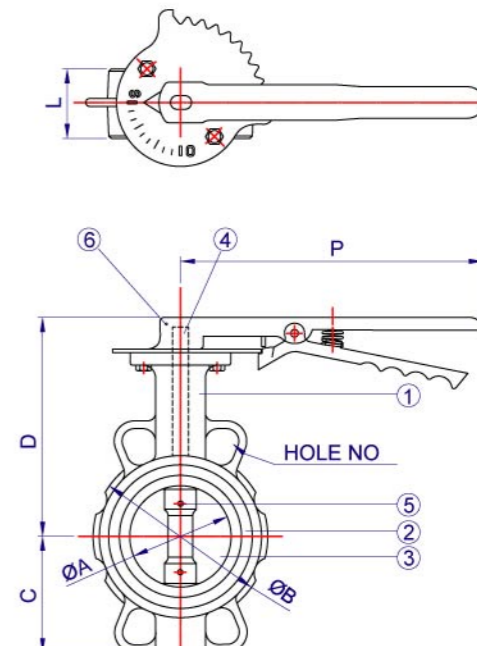

材質表 MATERIALS LIST:

NO.	部件名稱	PART NAME	材質	MATERIAL	DESCRIPTION	
					JIS	ASTM
1	閥體	BODY	鑄鐵	CAST IRON	FC200	A126 CLASS-B
			球墨鑄鐵	DUCTILE IRON	FCD450	A536-65-45-12
2	閥座	SEAT	橡膠	RUBBER	BUNA-N(NBR)	
					EPDM	
3	閥瓣	DISC	球墨鑄鐵	DUCTILE IRON	FCD450	A536-65-45-12
			不銹鋼	STAINLESS STEEL	SCS13	A351 CF8
4	閥杆	SHAFT	不銹鋼	STAINLESS STEEL	SUS410	A182 F410
					SUS316	A182 F316
					SUS304	A182 F304
					SCS13, SCS14	A182 F304 F316
5	定位銷	SET PIN	不銹鋼	STAINLESS STEEL	SCS13, SCS14	A182 F304 F316
6	手柄	LEVER HANDEL	球墨鑄鐵	DUCTILE IRON	FCD450	A536-65-45-12

尺寸表 DIMENSIONS:

NO.	INCH	2	2.5	3	4	5	6	8	10	12	14	16	18	20	24
		MM	50	65	80	100	125	150	200	250	300	350	400	450	500
閥門 VALVE	ØA	50	65	80	99	124	149	199	250	299	328	380	431	489	582
	ØB	101	121	131	157	189	217	265	330	377	413	478	537	593	693
	C	64	78	81	104	120	138	175	204	236	268	307	335	381	457
	HOLE NO	2	2	2	2	2	2	4	4	4	4	4	4	8	8
	L	43	46	46	52	56	56	60	68	78	78	102	114	127	154
手柄 LEVER	D	151	156	165	185	197	225	253	288	338	—	—	—	—	—
	P	220	220	220	220	220	220	350	350	350	—	—	—	—	—
	N	107	107	107	107	107	107	135	135	135	—	—	—	—	—

對夾式防結露蝶閥(齒輪式操作)

WAFER TYPE ANTI-DEW BUTTERFLY VALVE
(WORM GEAR OPERATION)



特徵 FEATURES:

法蘭標準 END FLANGE DIMENSION: ANSI150LB;JIS10K;PN10;PN16;
結構長度 FACE TO FACE DIMENSION: ISO5752 SHORT BODY;
測試標準 TEST: API 598.

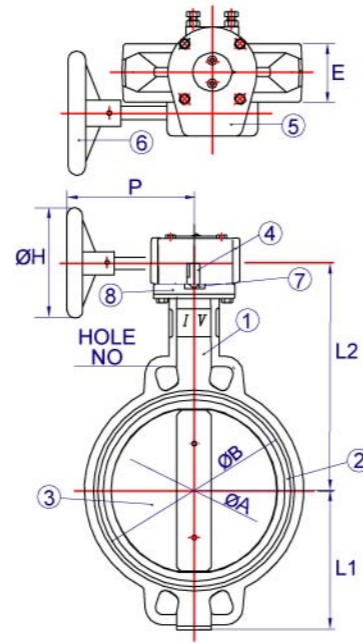

材質表 MATERIALS LIST:

NO.	部件名稱	PART NAME	材質	MATERIAL	DESCRIPTION	
					JIS	ASTM
1	閥體	BODY	鋁	ALUMINUM	ADC12	B108
					不銹鋼	STAINLESS STEEL
2	閥座	SEAT	橡膠	RUBBER	BUNA-N(NBR)	
					EPDM	
3	閥瓣	DISC	鑄鋼	CAST STEEL	WCB	A216 GR,WCB
					不銹鋼	STAINLESS STEEL
4	閥杆	SHAFT	不銹鋼	STAINLESS STEEL	SCS14	A351 CF8M
					SUS410	A182 F410
					SUS316	A182 F316
					SUS304	A182 F304
5	蝸輪傳動箱	WORM GEAR BOX	鑄鐵	CAST IRON	FC200	A126 CL-B
6	手輪	HANDLEWHEEL	鑄鐵	CAST IRON	FC200	A126 CL-B
7	高壓套管	HIGH-PRESSURE BUSHING	橡膠	RUBBER	EPDM	
8	頂板	TOP PLATE	工程塑膠	ENGINEERING PLASTIC	ABS(PAINTED ACRYLIC RESIN)	

尺寸表 DIMENSIONS:

NO.	INCH	2	2.5	3	4	5	6	8	10	12	14	16	18	20	24
		MM	50	65	80	100	125	150	200	250	300	350	400	450	500
閥門 VALVE	ØA	50	65	80	99	124	149	199	250	299	328	380	431	489	588
	ØB	98	118	128	153	184	214	265	327	371	421	481	535	625	695
	L1	66	79	91	110	124	140	176	210	240	274	315	345	390	465
	HOLE NO	2	2	2	2	2	2	4	4	4	4	4	4	8	8
	E	43	46	46	52	56	56	60	68	78	78	102	114	127	154
蝸輪 WORM GEAR	L2	198	208	216	233	246	267	339	351	413	440	450	480	558	635
	P	170	170	170	170	170	170	260	260	260	280	300	300	330	330
	ØH	160	160	160	160	160	160	250	250	250	305	305	305	457	457

對夾式防結露蝶閥(手柄式操作)

WAFER TYPE ANTI-DEW BUTTERFLY VALVE
(LEVER OPERATION)



特徵 FEATURES:

法蘭標準 END FLANGE DIMENSION: ANSI150LB;JIS10K;PN10;PN16;
結構長度 FACE TO FACE DIMENSION: ISO5752 SHORT BODY;
測試標準 TEST: API 598.

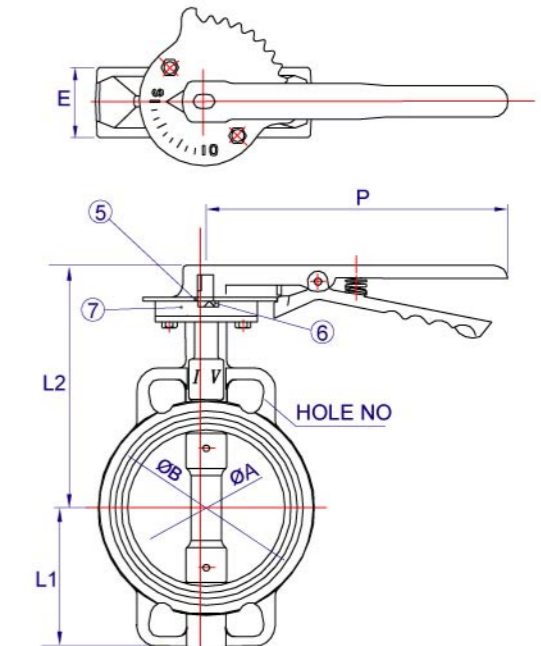

材質表 MATERIALS LIST:

NO.	部件名稱	PART NAME	材質	MATERIAL	DESCRIPTION	
					JIS	ASTM
1	閥體	BODY	鋁	ALUMINUM	ADC12	B108
					不銹鋼	STAINLESS STEEL
2	閥座	SEAT	橡膠	RUBBER	BUNA-N(NBR)	
					EPDM	
3	閥瓣	DISC	鑄鋼	CAST STEEL	WCB	A216 GR,WCB
					不銹鋼	STAINLESS STEEL
4	閥杆	SHAFT	不銹鋼	STAINLESS STEEL	SCS14	A351 CF8M
					SUS410	A182 F410
					SUS316	A182 F316
					SUS304	A182 F304
5	手柄	LEVER HANDEL	鑄鐵	CAST IRON	FC200, SUS304	A126 CL-B; A315 CF8
6	高壓套管	HIGH-PRESSURE BUSHING	橡膠	RUBBER	EPDM	
7	頂板	TOP PLATE	工程塑膠	ENGINEERING PLASTIC	ABS(PAINTED ACRYLIC RESIN)	

尺寸表 DIMENSIONS:

NO.	INCH	2	2.5	3	4	5	6	8	10	12	14	16	18	20	24
		MM	50	65	80	100	125	150	200	250	300	350	400	450	500
閥門 VALVE	ØA	50	65	80	99	124	149	199	250	299	328	380	431	489	588
	ØB	98	118	128	153	184	214	265	327	371	420	481	535	625	695
	L1	66	79	91	110	124	140	176	210	240	274	315	345	390	465
	HOLE NO	2	2	2	2	2	2	4	4	4	4	4	4	8	8
	L	43	46	46	52	56	56	60	68	78	78	102	114	127	154
手柄 LEVER	L2	198	208	216	230	249	262	303	338	378	—	—	—	—	—
	P	170	170	170	250	250	250	410	410	410	—	—	—	—	—
	N	107	107	107	107	107	107	135	135	135	—	—	—	—	—

對夾式偏心蝶閥(齒輪式操作)

WAFFER TYPE ECCENTRIC BUTTERFLY VALVE
(WORM GEAR OPERATION)

特徵 FEATURES:

法蘭規範 END FLANGE DIMENSION: ANSI150LB;JIS10K;PN10;PN16;
設計與製造標準 BASIC DESIGN: API 609;
測試標準 TEST: API 598.

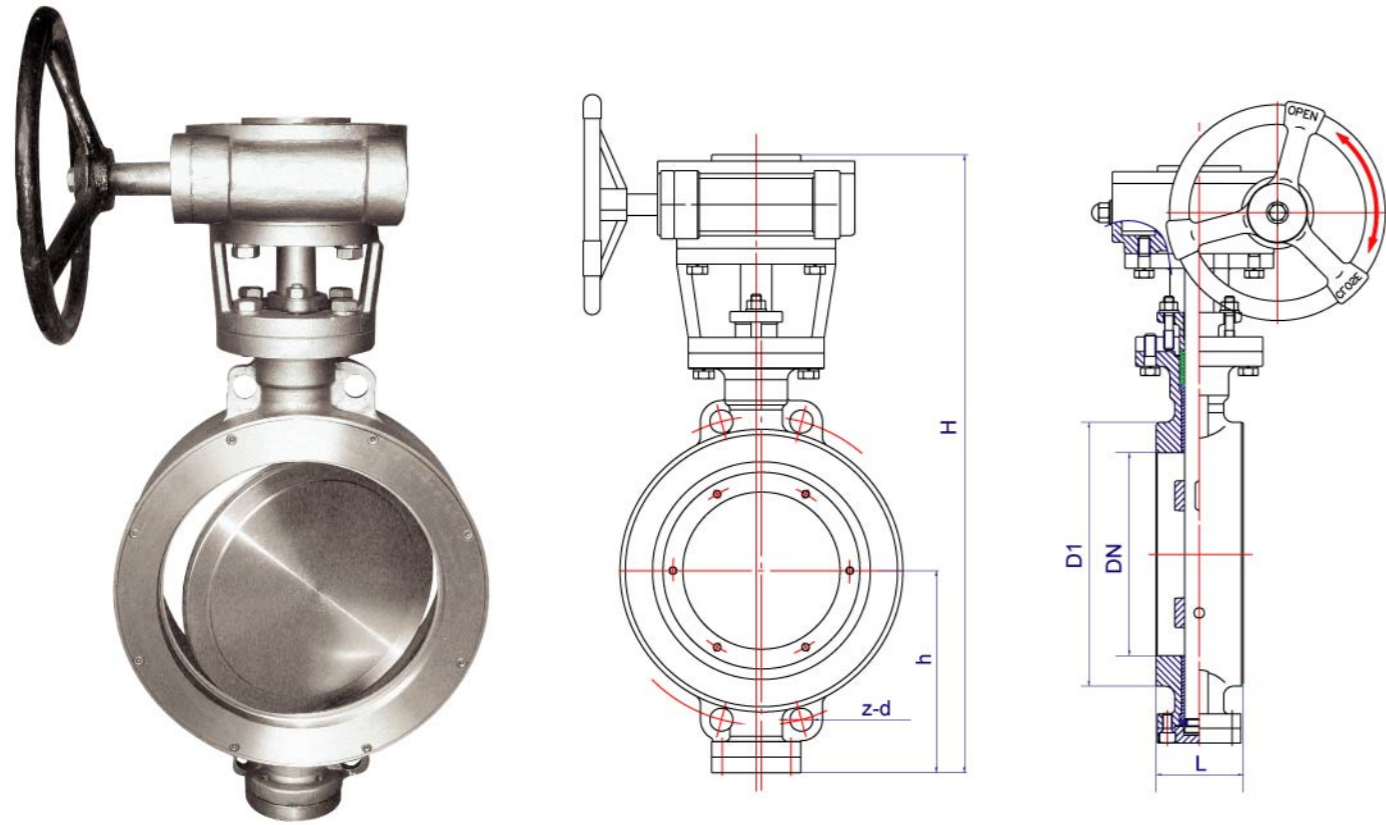

材質表 MATERIALS LIST:

NO.	部件名稱	PART NAME	材質 MATERIAL		
1	閥體	BODY	CF8	CF8M	WCB
2	閥瓣	DISC	CF8	CF8M	WCB
3	閥杆	SHAFT	304	316	410
4	球墊	SEAT	PTFE;METAL		

尺寸表 DIMENSIONS:

DN	50	65	80	100	125	150	200	250	300	350	400
d	96	116	133	158	186	215	266	325	376	425	470
L	43	46	48	54	57	57	64	71	81	92	102
h	63	73	95	105	125	150	220	250	290	310	345
H	320	340	375	410	455	520	650	700	820	840	925

對夾式偏心蝶閥(手柄式操作)

WAFFER TYPE ECCENTRIC BUTTERFLY VALVE
(LEVER OPERATION)

特徵 FEATURES:

法蘭規範 END FLANGE DIMENSION: ANSI150LB;JIS10K;PN10;PN16;
結構長度 FACE TO FACE DIMENSION: ISO5752 SHORT BODY;
測試標準 TEST: API 598.

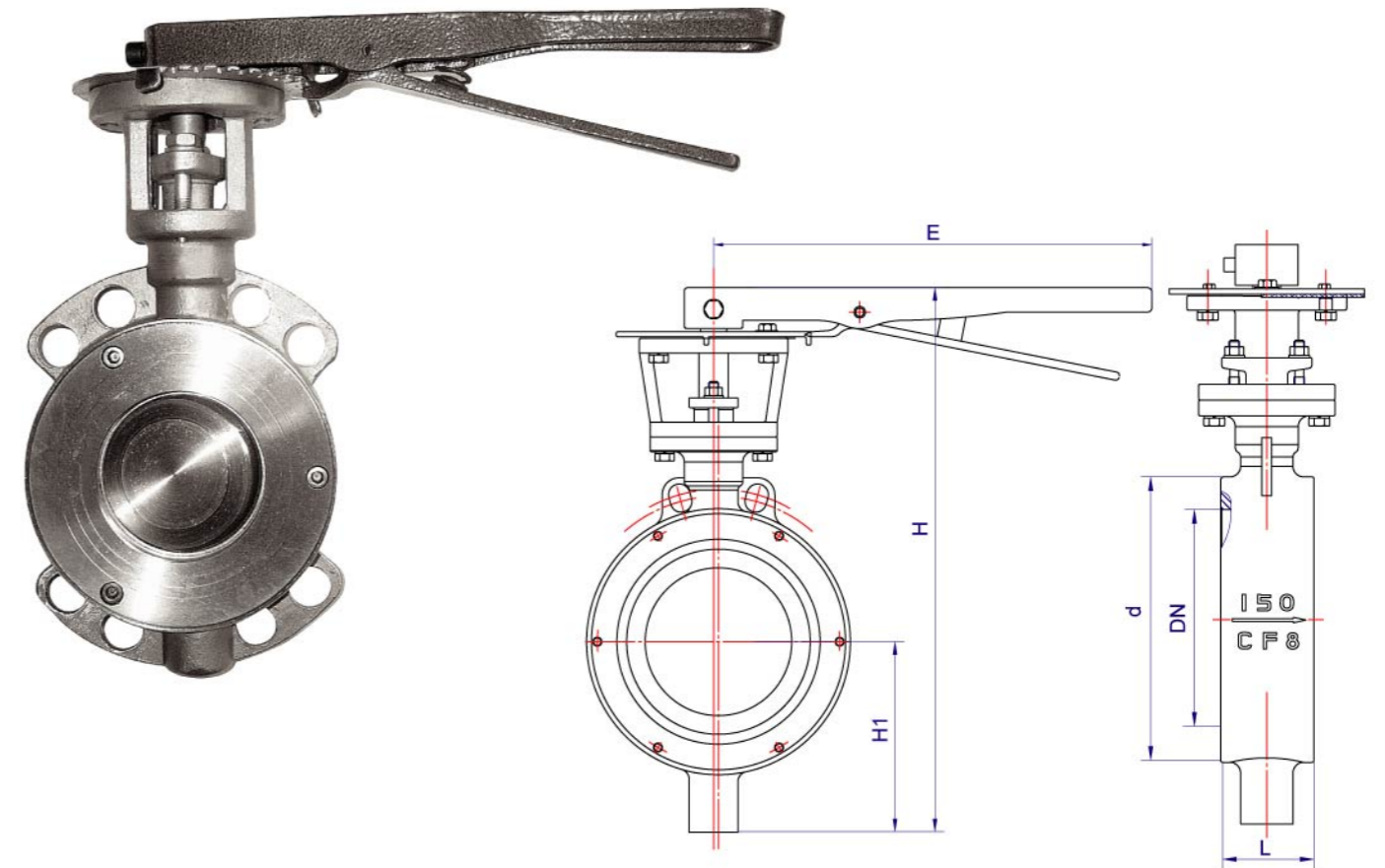

材質表 MATERIALS LIST:

NO.	部件名稱	PART NAME	材質 MATERIAL		
1	閥體	BODY	CF8	CF8M	WCB
2	閥瓣	DISC	CF8	CF8M	WCB
3	閥杆	SHAFT	S.S304	S.S316	2Gr13
4	球墊	SEAT	PTFE;304+多层次		

尺寸表 DIMENSIONS:

DN	50	65	80	100	125	150
d	96	116	133	158	186	215
L	43	46	48	54	57	57
h	63	73	95	105	125	150
H	290	310	345	380	420	470
E	225/267	225/267	225/267	225/267	310/345	310/345

多耳式蝶閥 (手柄式操作)

LUG TYPE BUTTERFLY VALVE
(LEVER OPERATION)



特徵 FEATURES:

法蘭標準 END FLANGE DIMENSION: ANSI150LB;JIS10K;PN10;PN16;
結構長度 FACE TO FACE DIMENSION: ISO5752 SHORT BODY;
測試標準 TEST: API 598.

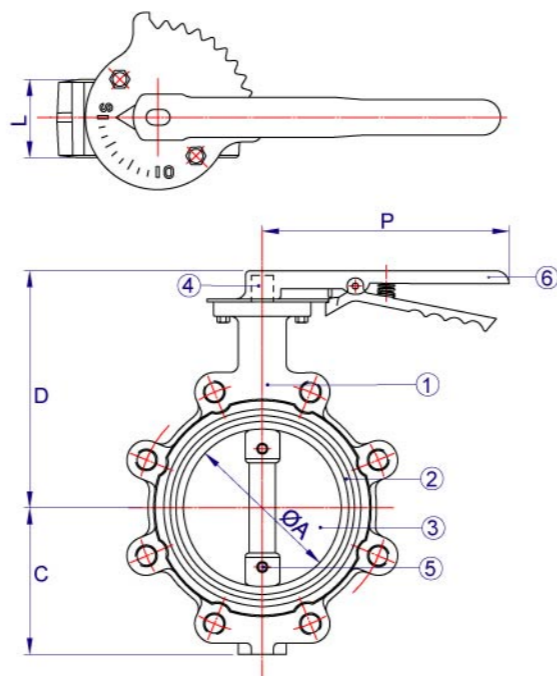

材質表 MATERIALS LIST:

NO.	部件名稱	PART NAME	材質	MATERIAL	DESCRIPTION			
					JIS	ASTM		
1	閥體	BODY	鑄鐵	CAST IRON	FC200	A126 CLASS-B		
					球墨鑄鐵	DUCTILE IRON	FCD450	A536-65-45-12
2	閥座	SEAT	橡膠	RUBBER	BUNA-N(NBR)			
					EPDM			
3	閥瓣	DISC	球墨鑄鐵	DUCTILE IRON	FCD450	A536-65-45-12		
					不銹鋼	STAINLESS STEEL	SCS13	A351 CF8
							SCS14	A351 CF8M
							SUS410	A182 F410
4	閥杆	SHAFT	不銹鋼	STAINLESS STEEL	SUS316	A182 F316		
							SUS304	A182 F304
							SUS304, SUS316	A182 F304 F316
5	定位銷	SET PIN	不銹鋼	STAINLESS STEEL	SUS304, SUS316	A182 F304 F316		
6	手柄	LEVER HANDLE	球墨鑄鐵	DUCTILE IRON	FCD450	A536-65-45-12		

尺寸表 DIMENSIONS:

NO.	INCH	DIMENSIONS															
		2	2.5	3	4	5	6	8	10	12	14	16	18	20	24		
閥門 VALVE	MM	50	65	80	100	125	150	200	250	300	350	400	450	500	600		
	ØA	50	65	80	99	124	149	199	250	299	328	380	431	489	588		
	C	66	79	91	110	124	140	176	210	240	274	315	315	390	465		
手柄 LEVER	L	43	46	46	52	56	56	60	68	78	78	102	114	127	154		
	D	168	178	186	200	219	232	263	298	333	—	—	—	—	—		
	P	170	170	170	250	250	250	410	410	410	—	—	—	—	—		

多耳式蝶閥 (齒輪式操作)

LUG TYPE BUTTERFLY VALVE
(WORM GEAR OPERATION)



特徵 FEATURES:

法蘭標準 END FLANGE DIMENSION: ANSI150LB;JIS10K;PN10;PN16;
結構長度 FACE TO FACE DIMENSION: ISO5752 SHORT BODY;
測試標準 TEST: API 598.

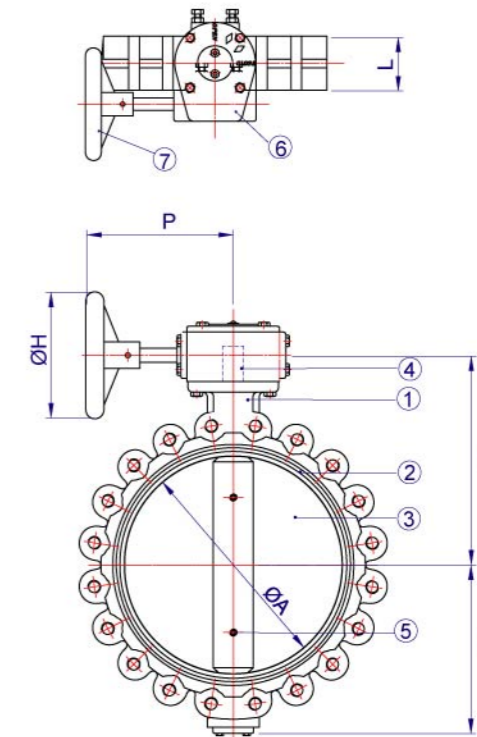

材質表 MATERIALS LIST:

NO.	部件名稱	PART NAME	材質	MATERIAL	DESCRIPTION			
					JIS	ASTM		
1	閥體	BODY	鑄鐵	CAST IRON	FC200	A126 CLASS-B		
					球墨鑄鐵	DUCTILE IRON	FCD450	A536-65-45-12
2	閥座	SEAT	橡膠	RUBBER	BUNA-N(NBR)			
					EPDM			
3	閥瓣	DISC	球墨鑄鐵	DUCTILE IRON	FCD450	A536-65-45-12		
					不銹鋼	STAINLESS STEEL	SCS13	A351 CF8
							SCS14	A351 CF8M
							SUS410	A182 F410
4	閥杆	SHAFT	不銹鋼	STAINLESS STEEL	SUS316	A182 F316		
							SUS304	A182 F304
							SUS304, SUS316	A182 F304 F316
5	定位銷	SET PIN	不銹鋼	STAINLESS STEEL	SUS304, SUS316	A182 F304 F316		
6	蝸輪傳動箱	WORM GEAR BOX	鑄鐵	CAST IRON	FC200	A126 CLASS-B		
7	手輪	HANDLEWHEEL	鑄鐵	CAST IRON	FC200,SGP	A126 CLASS B,A53		

尺寸表 DIMENSIONS:

NO.	IN	DIMENSIONS															
		2	2.5	3	4	5	6	8	10	12	14	16	18	20	24		
閥門 VALVE	MM	50	65	80	100	125	150	200	250	300	350	400	450	500	600		
	ØA	50	65	80	99	124	149	199	250	299	328	380	431	489	588		
	C	66	79	91	110	124	140	176	210	240	274	315	315	390	465		
蝸輪 WORM GEAR	L	43	46	46	52	56	56	60	68	78	78	102	114	127	154		
	D	168	178	186	203	216	237	289	321	373	390	400	430	498	575		
	P	170	170	170	170	170	170	260	260	260	280	300	300	330	330		
	ØH	160	160	160	160	160	160	250	250	250	305	305	305	457	457		

對夾雙瓣式止回閥

WAFFER TYPE DUAL-PLATE CHECK VALVE



鑄鐵 (CAST IRON)



不鏽鋼 (STAINLESS STEEL)

特徵 FEATURES:

法蘭標準 END FLANGE DIMENSION: ANSI150LB;JIS10K;PN10;PN16;
結構長度 FACE TO FACE DIMENSION: EN-558-1 SERIAL 50;
測試標準 TEST: API 598.

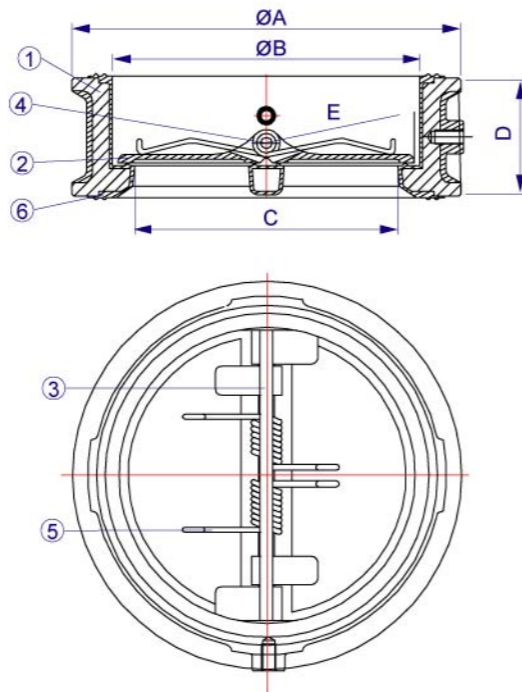

材質表 MATERIALS LIST:

NO.	部件名稱	PART NAME	材料 MATERIAL		附註 REMARK
			JIS	ASTM	
1	閥體	BODY	FC200,FC450	A126-B/A536	1
2	閥板	PLATE	SCS13/SCS14	A351-CF8/CF8M	2
3	檔板軸	STOP SHAFT	SUS304	A182 F304	1
4	軸杆	STEM	SUS304	A182 F304	1
5	彈簧	SPRING	SUS316	A182 F316	1 1/2"- 6" : 1 8"- 20" : 2 24" UP : 3
6	閥座	SEAT(Full-Liner)	BUNA-N(NBR),EPDM,VITON		1

尺寸表 DIMENSIONS:

SIZE		ØA						ØB	C	D	E		
Inch	mm	10K	16K	20K	125/150P	PN10/PN16	PN25/PN40						
1 1/2"	40A	86				94		64	40	54	29		
2"	50A	101				105		72	45	54	32		
2 1/2"	65A	121				124		80	50	54	35		
3"	80A	131	137					91	67	57	43		
4"	100A	156	162	175		164		119	90	64	53		
5"	125A	187	197		194		196	141	112	70	65		
6"	150A	217	235	222		220		226	171	137	80		
8"	200A	267	279			275		-	226	188	95	108	
10"	250A	330	353	340		331		345	355	281	240	108	132
12"	300A	375	403	410		386		403	420	327	282	143	154
14"	350A	420	447	451		438		-	-	362	310	184	170
16"	400A	483	507	511		491		-	-	420	360	191	200
18"	450A	538	572	549		541	558	-	-	462	406	203	206
20"	500A	592	627	606		596	620	-	-	512	457	213	242
24"	600A	697	731	718		698	737	-	-	614	558	222	295

安全閥

TC-1000L CAST BRONZE

BRONZE SAFETY VALVE WITH LEVER

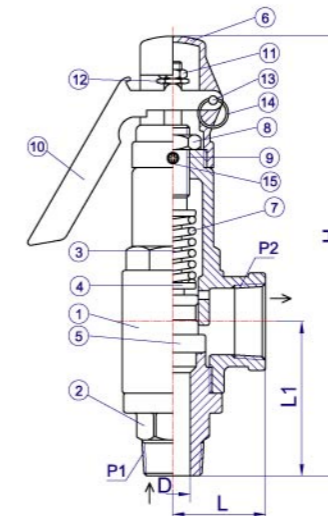

尺寸表 DIMENSIONS:

NOMINAL SIZE		P1	P2	D	L	L1	H	
P1XDXP2								
1/2"	13	1/2"	PT1/2"	PT1/2"	13	32	52	162
3/4"	19	3/4"	PT3/4"	PT3/4"	19	36	58	172
1"	25	1"	PT 1"	PT 1"	25	49	71	204
1 1/4"	32	1 1/4"	PT1-1/4"	PT1-1/4"	32	52	83	223
1 1/2"	38	1 1/2"	PT1-1/2"	PT1-1/2"	38	53	96	252
2"	50	2"	PT 2"	PT 2"	50	60	103	287

安全閥

TC-1000S CAST BRONZE

BRONZE SAFETY VALVE WITH SEALING

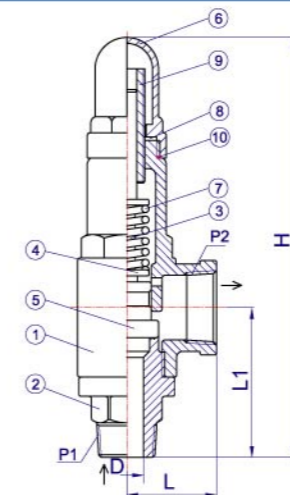

尺寸表 DIMENSIONS:

NOMINAL SIZE		P1	P2	D	L	L1	H	
P1XDXP2								
1/2"	13	1/2"	PR1/2"	PR1/2"	13	32	52	140
3/4"	19	3/4"	PR3/4"	PR3/4"	19	36	58	150
1"	25	1"	PR 1"	PR 1"	25	40	71	185
1 1/4"	32	1 1/4"	PR11/4"	PR11/4"	32	52	83	208
1 1/2"	38	1 1/2"	PR11/2"	PR11/2"	38	58	96	236
2"	50	2"	PR 2"	PR 2"	50	65	103	265

特徵 FEATURES:

非腐蝕性氣體 NONCORROSIVE GAS: NG
腐蝕性氣體 CORROSIVE GAS: CG
蒸汽 STEAM: S
熱水 HOT WATER: HW
非腐蝕性液體 NONCORROSIVE LIQUID: NL
腐蝕性液體 CORROSIVE LIQUID: CL

NO	ITEM	SPECIFICATION
1	MAIN MATERIAL(OTHERS)	STAINLESS STEEL (CASTING)
2	WORKING MEDIUM	NG,CG,S, HW,NL,CL
3	WORKING TEMP.	-196°C~225°C

材質表 MATERIALS LIST:

NO.	名稱	PART NAME	材料 MATERIAL
1	閥體	BODY	CASTING-BRONZE
2	閥座	SEAT	FORGING-BRASS
3	軸杆	SPINDLE	BRASS
4	彈簧座	SPRING SEAT	BRASS
5	閥瓣	DISC	FORGING-BRASS
6	閥蓋	CAP	CASTING-BRONZE
7	彈簧	SPRING	STEEL
8	調節螺母	ADJUST NUT	BRASS
9	調節螺絲	ADJUST SCREW	BRASS
10	把手	HANDEL	STEEL
11	六角螺母	HEXAGON NUT	STEEL
12	螺母	NUT	BRASS
13	銷	INSERT PIN	STEEL
14	拉環	RING	STEEL
15	十字螺絲	FIXTURE SCREW	STEEL

特徵 FEATURES:

非腐蝕性氣體 NONCORROSIVE GAS: NG
腐蝕性氣體 CORROSIVE GAS: CG
蒸汽 STEAM: S
熱水 HOT WATER: HW
非腐蝕性液體 NONCORROSIVE LIQUID: NL
腐蝕性液體 CORROSIVE LIQUID: CL

NO	ITEM	SPECIFICATION
1	MAIN MATERIAL(OTHERS)	STAINLESS STEEL (CASTING)
2	WORKING MEDIUM	NG,CG,S, HW,NL,CL
3	WORKING TEMP.	-196°C~225°C

材質表 MATERIALS LIST:

NO.	名稱	PART NAME	材料 MATERIAL
1	閥體	BODY	CASTING-BRONZE
2	閥座	SEAT	FORGING-BRASS
3	軸杆	SPINDLE	BRASS
4	彈簧座	SPRING SEAT	BRASS
5	閥瓣	DISC	FORGING-BRASS
6	閥蓋	CAP	CASTING-BRONZE
7	彈簧	SPRING	STEEL
8	調節螺母	ADJUST NUT	BRASS
9	調節螺絲	ADJUST SCREW	BRASS
10	墊片	WASHER	ASBESTOS

鑄鐵蒸汽祛水器 (牙口手動式)

CAST IRON STEAM TRAPS
(SCREWED END HAND OPERATED)

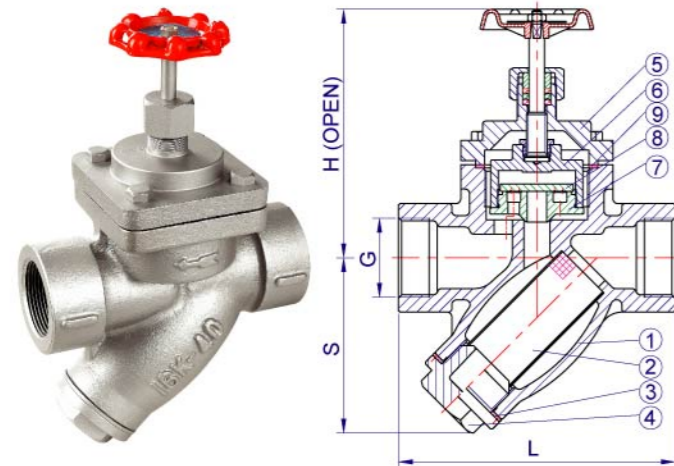

材質表 MATERIALS LIST:

NO.	名稱	PART NAME	材料 MATERIAL
1	閥體	BODY	CAST IRON(FC20)
2	過濾網	SCREEN	SS304
3	大薄片	GASKER	ASDESTOS
4	螺母	NUT	CAST IRON(FC20)
5	閥蓋	BONNET	CAST IRON(FC20)
6	螺母	NUT	CAST IRON(FC20)
7	閥瓣	DISC	ANSI 420
8	閥片	VALVE PLATE	SS304
9	大薄片	WASHER	ASDESTOS

使用壓力WORKING PRESSURE(kg/cm ²)	0.35-16
使用溫度WORKING TEMP.(°C)	220°C

尺寸表 DIMENSIONS:

SIZE	L	S	H	G
1/2"	97	77	153	1/2"PT, NPT, PF
3/4"	107	77	156	3/4"PT, NPT, PF
1"	113	94	159	1"PT, NPT, PF
1-1/4"	171	108	159	1-1/4"PT, NPT, PF
1-1/2"	171	108	159	1-1/2"PT, NPT, PF
2"	200	121	175	2"PT, NPT, PF

1.DR911 CAST IRON/FC20

材質表 MATERIALS LIST:

NO.	名稱	PART NAME	材料 MATERIAL
1	閥體	BODY	CAST IRON(FC20)
2	過濾網	SCREEN	SS304
3	大薄片	GASKER	ASDESTOS
4	螺母	NUT	CAST IRON(FC20)
5	閥蓋	BONNET	CAST IRON(FC20)
6	螺母	NUT	CAST IRON(FC20)
7	閥瓣	DISC	ANSI 420
8	閥片	VALVE PLATE	SS304
9	大薄片	WASHER	ASDESTOS

使用壓力WORKING PRESSURE(kg/cm ²)	0.35-16
使用溫度WORKING TEMP.(°C)	220°C

尺寸表 DIMENSIONS:

SIZE	L	S	H	G
1/2"	97	77	62	1/2"PT, NPT, PF
3/4"	107	77	65	3/4"PT, NPT, PF
1"	113	94	69	1"PT, NPT, PF
1-1/4"	171	108	81	1-1/4"PT, NPT, PF
1-1/2"	171	108	81	1-1/2"PT, NPT, PF
2"	200	121	98	2"PT, NPT, PF

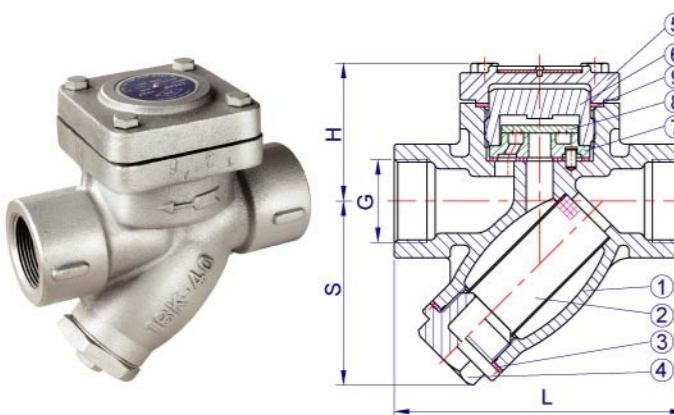

鑄鐵倒筒式蒸汽祛水器

CAST IRON INVERTED BUCKET
TYPE STEAM TRAPS

特徵 FEATURES:

最高操作壓力、溫度17kg/cm²(1.7mpa,250psi)x230°C;
最大排量9,000kg/hr;
構造簡單,不易故障
無插銷或鉸鏈結構,無固定磨損
阻擋蒸汽,節能效果佳
耐磨鎳鋼閥座,不銹鋼結構,使用壽命特長
間歇性排放,難質均可沖走,不積垢耐髒
操作中亦能排除不凝結氣體
有多種節流孔選擇,在不同壓力下,可選最高排水能量
抗背壓力強,適宜冷凝水回收系統使用
遇冷凝水立即反應
拆蓋可更換零件,不動配管
各型號均可改裝為鑄鐵倒筒式空氣祛水器
全不銹鋼內件抵抗腐蝕

Mop:17kg/cm²(1.7mpa,250psi)x230°C;
Max.capacity:9,000kg/hr;
Mechanism is simple, not easy to be damaged;
Frictionless mechanism,no pivots;
Remarkable steam conservation efficiency;
Hardened seat & valve for long service years;
Intermittent emission,impurities can be washed,and won't left bilge;
Vent non-condensable gas during operation;
Different orifice for various pressure operation;
High back pressure operation;
Response imediately when come into the condensate water;
Renewable accessory;
Can be remodified to air service;
All stainless steel internal parts against corrosion.

材質表 MATERIALS LIST:

NO.	部件名稱	PART NAME	材料	MATERIAL
1	閥體	BODY	鑄鐵	ASTM A48 CLASS.30.CAST IRON
2	機械結構	MECHANISM	不銹鋼	STAINLESS STEEL
3	倒筒	BUCKET	不銹鋼,4號 以上加鑄鐵 配重	STAINLESS STEEL. TRAP NO.984,994,44&UP WITH CAST IRON WT.
4	閥座	SEAT	硬鎳鋼	HARDENED S.S.440C
5	內管	INLET TUBE	鋼管	STEEL PIPE
6	墊片	GASKET	非石棉	COMPRESSED NON-ASBESTOS
7	過濾器	STRAINER	不銹鋼	STAINLESS STEEL
8	螺絲	BOLTS	碳鋼	CARBON STEEL
9	螺帽	NUTS	碳鋼	CARBON STEEL

連續排水量表, 公斤/小時

CONTINUOUS DISCHARGE CAPACITY OF CONDENSATE IN KG/HR

TRAP NO	980	981	982	983	984	985	986	
		991	992	993	994	995	996	
		41	42	43	44	45	46	
ΔP.KG/CM ²	0.5	240	420	800	1,520	2,500	3,960	7,190
	1	280	470	930	1,750	2,950	4,500	8,600
	2	230	460	930	1,800	3,020	4,500	8,150
	4	280	410	920	2,000	3,050	4,400	8,800
	8	280	380	800	1,560	2,600	4,600	8,000
	9	310	420	900	1,750	2,950	4,900	8,850
	10	260	365	660	1,550	2,550	4,500	8,450
	12		380	720	1,730	2,880	4,850	9,000
	15		335	560	1,500	2,500	3,000	8,400
	17		350	600	1,550	2,600	3,200	8,650

選擇時要考慮2~3倍的安全係數.2-3 times safety factor of condensate load should always be considered to select proper steam traps.

鑄鐵倒筒式蒸汽祛水器

CAST IRON INVERTED BUCKET TYPE STEAM TRAPS

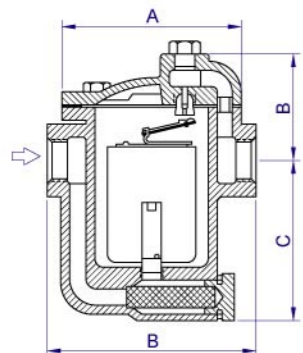

TRAP NO.980 SERIES DIMENSIONS(MM).MOP(KG/CM²).WT(KG).

TRAP NO.	CONN.SE.*	A	B	C	D	MOP	WT
980	15.20	96	76	70	128	10	2.2
981	15.20.25	96	76	100	128	17	2.8
982	20.25	145	96	137	170	17	7.0
983	25.32	180	121	193	202	17	14.0
984	32.40	203	150	212	232	17	23.0
985	40.50	220	148	248	250	17	26.0
986	50	275	214	242	302	17	42.0

- *GZ. NPT. PT. BSPT available
- TRAP NO.980 series sidein & sideout. screwed end with integral strainer.
- TRAP NO.986 without strainer

- *可提供 GZ.NPT.PT.BSPT;
- TRAP NO.980 系列蒸汽祛水器,管螺紋接口,側面進出,內附過濾器;
- TRAP NO.960 蒸汽祛水器無過濾器;
- MOP 最高操作壓力。

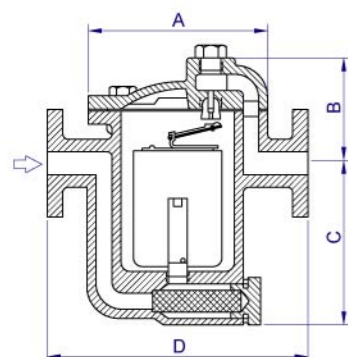

TRAP NO.990 SERIES DIMENSIONS.MOP.&WT.

TRAP NO.	CONN.FE.	A	B	C	D	MOP	WT
991	15.20.25	96	76	100	170	17	5
992	20.25	145	94	137	218	17	10
993	25	180	121	193	253	17	18
994	32.40	203	150	212	279	17	27
995	40.50	220	148	248	304	17	29
996	50.65.80	275	214	242	374	17	45

- Flange made to JIS 10K or ANSI 150#RF.
- Other flange spec. pls consult factory.
- TRAP NO.990 series. sidein & sideout. flange end with integral strainer.
- TRAP NO.996 without strainer.

- JIS 10K OR ANSI 150#RF 法蘭面
- 其他特殊的法蘭面諮詢廠商。
- TRAP NO.990系列蒸汽祛水器,法蘭接口,側面進出,內附過濾器,法蘭規格請詳列。
- TRAP NO.996蒸汽祛水器無過濾器。

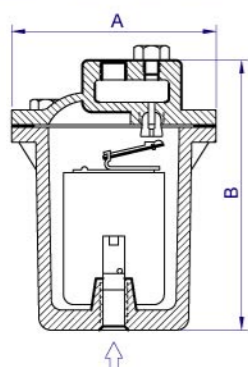

TRAP NO.40 SERIES DIMENSIONS.MOP.&WT.

TRAP NO.	CONN.SE.*	A	B	MOP	WT
41	15	108	62	17	2.8
42	20	133	203	17	5.5
43	25	162	273	17	9.5
44	32	184	314	17	16
45	40	216	380	17	21.5
46	50	260	432	17	35

- TRAP NO.40 series. bottom inlet & top outlet.
- TRAP NO.980.990.40 series check valve are available.in all ib traps.
- ib traps can be remodified to air service. pls add"a"to trap No. for air trap.

- TRAP NO.40 系列蒸汽祛水器,管螺紋接口,下進上出,無過濾器。
- TRAP NO.980.990.40 系列祛水器,內部皆可安裝逆止閥。或改裝為倒筒式空氣祛水器,詳情請洽詢。

全不銹鋼倒筒式蒸汽祛水器

ALL STAINLESS STEEL INVERTED BUCKET TYPE STEAM TRAPS

特徵 FEATURES:

- 最高操作壓力、溫度41kg/cm²(4.1mpa,600psi)x425°C;
- 最大排量:9,000kg/hr;
- 700,740,771系列,全密封型,外形簡潔
- 外殼不銹鋼適宜腐蝕性環境及衛生要求高之場所
- 重量性、體積小、耐壓高、抗結凍
- 771型與S-77型溫差式可互換使用
- 無條件保壹年
- 780系列可更換零件

- Mop:41kg/cm²(4.1mpa,600psi)x425°C;
- Max.capacity:9,000kg/hr;
- 700,740,771series,full seals;
- S.S shell, available for erosion and sanitation services;
- light,small,withstand voltage,anti-freeze;
- Type 711 and s-77 are replaceable;
- The warranty is one year;
- The accessory of 780 series are renewable.

材質表 MATERIALS LIST:

NO.	部件名稱	PART NAME	材料	MATERIAL
1	本體	BODY	不銹鋼	770,740,771,701S,S.S.304
			不銹鋼	780,771,CONNECTOR S.S.316
2	機械結構	MECHANISM	不銹鋼	STAINLESS STEEL
3	倒筒	BUCKET	不銹鋼	STAINLESS STEEL
4	閥座	SEAT	硬鉻鋼	HARDENED S.S.440C
5	內管	INLET TUBE	不銹鋼	STAINLESS STEEL
6	墊片	GASKET	非石棉	780 SERIES,COMPRESSED NON-ASBESTOS
7	過濾器	STRAINER	不銹鋼	STAINLESS STEEL
8	螺絲帽	SOLTS & NUTS	不銹鋼	STAINLESS STEEL

連續排水量表, 公斤/小時

CONTINUOUS DISCHARGE CAPACITY OF CONDENSATE IN KG/HR

TRAP NO	740	701 701S 741 771 780	871	702 742 772	703 743	704 744	745	746
	1	280	470	500	930	1,750	2,950	4,500
2	230	460	500	930	1,800	3,020	4,500	8,150
4	280	410	500	920	2,000	3,050	4,400	8,800
6	270	385	430	820	1,500	3,100	4,300	7,700
9	310	420	500	900	1,750	2,950	4,900	8,850
10	260	365	520	660	1,550	2,550	4,500	8,450
12		380	430	720	1,730	2,880	4,850	9,000
15		335	450	560	1,500	2,500	4,700	8,400
17		350	460	600	1,550	2,600	3,200	8,650
20		240	400	620	1,250	2,250	3,500	7,300
28		270	370	540	1,450	1,910	3,150	6,400
30			400	570	1,500	1,950	3,350	6,800
34			390					
41			410					

選擇時要考慮2~3倍的安全係數.2-3 times safety factor of condensate load should always be considered to select proper steam traps.

全不銹鋼倒筒式蒸汽祛水器

ALL STAINLESS STEEL INVERTED BUCKET TYPE STEAM TRAPS

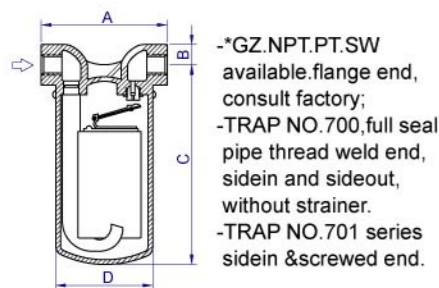

-*GZ.NPT.PT.SW available, flange end, consult factory;
-TRAP NO.700, full seal pipe thread weld end, sidein and sideout, without strainer.
-TRAP NO.701 series sidein & screwed end.

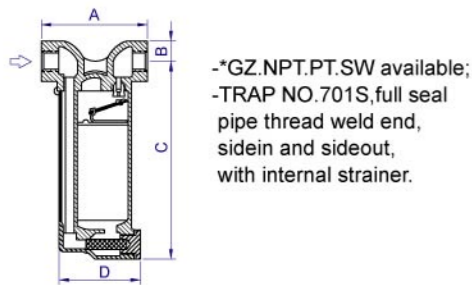

-*GZ.NPT.PT.SW available;
-TRAP NO.701S, full seal pipe thread weld end, sidein and sideout, with internal strainer.

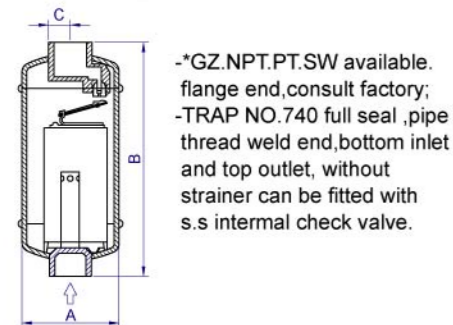

-*GZ.NPT.PT.SW available, flange end, consult factory;
-TRAP NO.740 full seal, pipe thread weld end, bottom inlet and top outlet, without strainer can be fitted with s.s internal check valve.

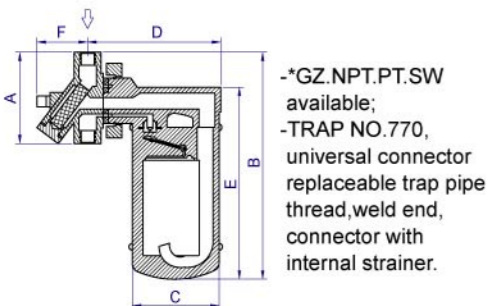

-*GZ.NPT.PT.SW available;
-TRAP NO.770, universal connector replaceable trap pipe thread, weld end, connector with internal strainer.

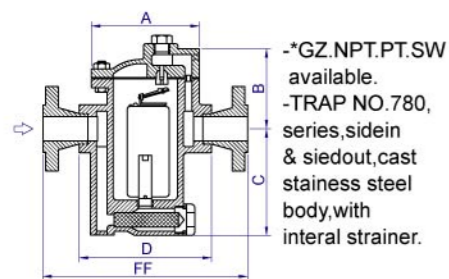

-*GZ.NPT.PT.SW available.
-TRAP NO.780, series, sidein & sideout, cast stainless steel body, with internal strainer.

-ANSI B16.5, 150#RF, 300#RF, 600#RF flanges are standard, other flange spec. please consult factory;
-S.S. internal check valve available.

TRAP NO.700 SERIES DIMENSIONS(MM).MOP(KG/CM²).WT(KG).

TRAP NO.	CONN.SE.*	A	B	C	D	MOP	WT
701	15.20.25	96	19	163	64	28	1
702	20.25	120	23	208	90	30	2
703	25.32	145	29	264	114	30	4.3
704	32.40	170	32	265	140	30	6

-*可提供GZ.NPT.PT.SW末端,法蘭末端諮詢廠商。
-TRAP NO.700,全密封、管螺紋、焊口、側面進出、無過濾器;
-TRAP NO.701,側面進出,末端螺紋。

TRAP NO.701S DIMENSIONS MOP.WT.

TRAP NO.	CONN.SE.*	A	B	C	D	MOP	WT
701S	15.20.25	96	19	179	80	28	1.3

-*可提供GZ.NPT.PT.SW末端;
-TRAP NO.701S,全密封、管螺紋、焊口、側面進出、內附過濾器。

TRAP NO.740 SERIES DIMENSIONS.MOP.WT.

TRAP NO.	CONN.SE.*	A	B	C	MOP	WT
741	15.20.	70	154	14	10	0.7
742	20	70	184	14	28	0.8
743	20	90	225	22	30	1.6
744	25	114	289	30	30	3.5
745	40	140	360	0	30	5.7
746	50	190	425	0	30	10

-*可提供GZ.NPT.PT.SW末端,法蘭末端請諮詢廠商。
-TRAP NO.740,全密封、管螺紋、焊口、側面進出、無過濾器、可加裝不銹鋼逆止閥。

TRAP NO.770 DIMENSIONS MOP.WT.

TRAP NO.	CONN.SE.*	A	B	C	D	E	F	MOP	WT
771	15.20.25	96	205	64	105	153	67	28	2
772	15.20.25	96	257	89	130	205	67	30	3.2

-*可提供GZ.NPT.PT.SW末端;
-TRAP NO.770, 萬象接頭,僅拆二只螺絲即可更換祛水器;管螺紋、焊口、接頭內附過濾器。

TRAP NO.780 SERIES DIMENSIONS MOP.WT.

TRAP NO.	CONN.SE.*	A	B	C	D	MOP	WT
780	15.20	104	80	98	126	28	3
781	15.20.25	116	105	94	136	41	5

-*可提供GZ.NPT.PT.SW末端;
-TRAP NO.780,可拆,全不銹鋼本體;管螺紋、焊口、側面進出、內附過濾器、可加裝不銹鋼逆止閥。

TRAP NO.780F SERIES DIMENSIONS. MOP.WT.

TRAP NO.	CONN.FE.*	150#	300#	600#
780F	15	212	212	
	20	224	230	
781F	15	219	219	229
	20	231	237	237
	25	236	245	245

-ANSI B16.5,150#RF,300#RF,600#RF法蘭面是標準的,其他的法蘭規格請諮詢廠商。
-可加裝不銹鋼逆止閥;
-TRAP NO.780F,法蘭接口,法蘭規格請詳列,所有型號可改裝為倒筒式空氣祛水器,詳情請諮詢。

鍛鋼倒筒式蒸汽祛水器

FORGED STEEL INVERTED BUCKET TYPE STEAM TRAPS

特徵 FEATURES:

最高操作壓力、溫度183kg/cm²(18.3mpa,2700psi)x530°C
最大排量:8600kg/hr.
構造簡單,不易故障
鍛鋼本體耐壓高,抗結凍
適用於石化、電力、化工、汽電共生等較高要求場所
可選管螺紋、焊口或各種法蘭口配合使用
全部使用不銹鋼包石墨過捲墊片,耐高溫壓
可用於過熱蒸汽,適用高壓,高溫操作
可更換零件,不必整組換新

Mop:183kg/cm²(18.3mpa,2700psi)x530°C
Max.capacity:8600kg/hr.
Mechanism is simple, not easy to be damaged;
Forged steel body, stand high pressure, anti-freeze;
Applicable to the petrochemical, electric station, chemical and so on;
Can used with pipe thread, weld end and different kinds of flange end.
Can be used for superheated steam and suit for high pressure high temperature.
Renewable accessory.

材質表 MATERIALS LIST:

SIZE	部件名稱	PART NAME	材質	MATERIAL
1	本體	BODY	CAST S.S.316	ASTM A-105
		NO.642-646	AVAILABLE	
		NO.943-946	鑄不銹鋼可供應	STAIM A-182, F-11
2	機械結構	MECHANISM	鍛造合金鋼	STAIM A-182, F-22
			不銹鋼	STAINLESS STEEL
3	倒筒	BUCKET	不銹鋼,加鑄鐵配重	640&94 SERIES, STAINLESS W/ CAST IRON WT.
			不銹鋼	1540-2540 SERIES, ALL STAINLESS STEEL
4	閥座	SEAT	硬鉻鋼	HARDENED S.S.440C
5	內管	INLET TUBE	鋼管	STEEL PIPE
6	墊片	GASKET	不銹鋼包石墨	640 & 940 SERIES, 1540-2540 SERIES, S.S.304 W/GRAPHITE
7	過濾器	STRAINER	合金鋼	ASTM A-193, GR. B7
8	螺絲帽	NUTS	合金鋼	ASTM A-194, GR. 2H

連續排水量表, 公斤/小時

CONTINUOUS DISCHARGE CAPACITY OF CONDENSATE IN KG/HR

TRAP NO	642	643	644	645	646	941	951	943	945	946	1543	1545	2545	
	642F	643F	644F	645F	646F	941F	951F	943F	945F	946F	1543F	1545F	2545F	
ΔP.KG/CM ²	17	810	1550	2550	3200	8650	230	230	1550	3200	8650			
	20	880	1250	2250	3500	7300	250	250	1250	3500	7300			
	27	980	1390	1800	3100	6300	275	275	1390	3100	6300			
	34	770	1050	2000	3400	7050	300	300	1050	3400	7050			
	41	815	1100	1580	2560	6050	345	345	1100	2560	6050			
	50						380	380	1150	2700	4120			
	62						410	410	1220	2080	4400	1220	2080	
	69						430	430	1300	2200	4550	1270	2200	
	75											1250	2150	
	102											1025	1755	3.9-2960
	135													3.1-2150
	170													2.7-1680
	183													

選擇時要考慮2~3倍的安全係數.2-3times safety factor of condensate load should always be considered to select proper steam traps.

鍛鋼倒筒式蒸汽祛水器

FORGED STEEL INVERTED BUCKET
TYPE STEAM TRAPS

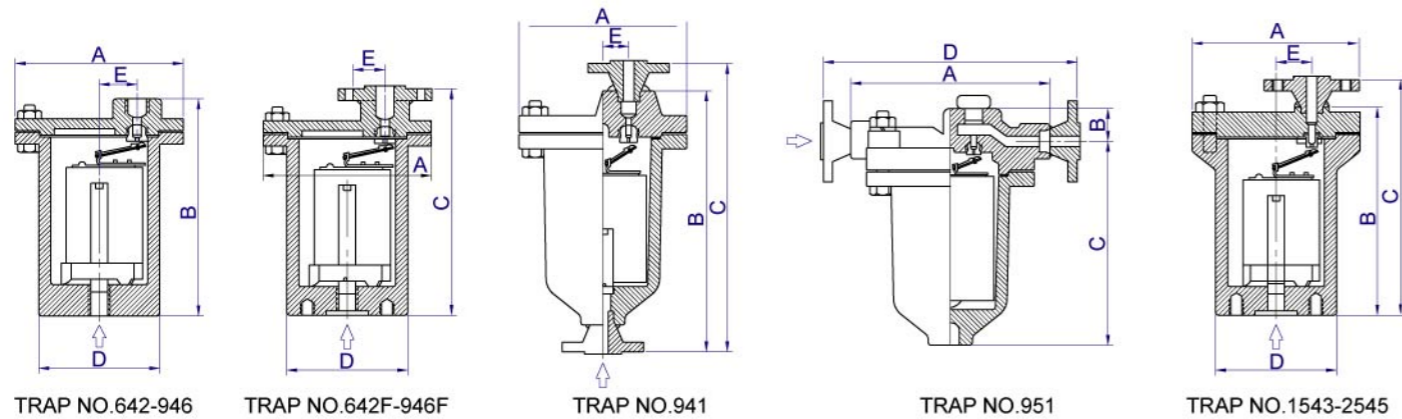

TRAP NO.642-2545 SERIES DIMENSIONS(MM). MOP(KG/CM²). WT(KG).

TRAP NO.	CONN.	A	B	C	D	E	MOP	WT SE.SW.	WT.FLG
642.642F	15.20	171	259	313	121	32	41	14	15
643.643F	20.25	203	292	352	130	37	45	22	23
644.644F	25.32	219	348	408	146	38	45	34	36
645.645F	25.32.40	248	381	446	169	45	45	42	44
646.646F	40.50	302	435	500	218	54	45	73	75
941.941F	15.20	161	225	354	0	19	69	11	12
951.951F	15.20.25	200	35	298	273	0	69	16	17
943.943F	15.20.25	219	305	378	135	37	69	30	33
945.945F	25.32.40	273	379	459	175	45	69	56	62
946.946F	40.50	318	448	546	216	54	69	89	91
1543.1543F	15.20.25	216	362	426	146	34	102	45	48
1545.1545F	25.32.40	264	413	505	194	45	124	88	95
2545.2545F	25.32	299	613	714	213	45	183	135	140

-TRAP NO.642~946系列蒸汽祛水器,管螺紋口、焊口,均可提供。

-NO.1543-2545系列蒸汽祛水器有焊口及法蘭口。

-F代表法蘭接口,如需法蘭接口請洽廠商並詳列法蘭規格,所有型號可改裝為倒筒式空氣祛水器,詳情請詢可加裝不銹鋼逆止閥,TRAP NO.951除外。

-所有以上祛水器都可按照ANSI B1.6法蘭標準完成,其他規格請諮詢廠商。

-NO. 642-946 traps are available with screwed end, socket weld connections.

-NO.1543-2545 traps are available in sw connections.

-F stand for flange end,if need flange end, please consult factory and list the flange specification, all model can be remodified to inverted, bucket type air traps, details please consult factory. can be fitted with S.S internal check valve, besides trap No. 951.

-All above traps are able to be furnished with ANSI B1.6 flanges, other spec. please consult factory.

本體耐溫壓對照表 PRESSURE VS TEMPERATURE TRAP BODY RATING

TRAP NO	MAX. OPER. PRESSURE SAT. STEAM KG/CM ²	MAX. ALLOWABLE PRESSURE, KG/CM ²					
		340°C	400°C	450°C	480°C	500°C	530°C
642	41	41	38	35			
643	45	70	60	45			
644	45	70	60	45			
645	45	70	60	45			
646	45	70	60	45			
941	69	69	65	50			
951	69	69	65	50			
943	69	80	80	70	50		
945	69	76	75	74	65		
946	69	115	110	90	65		
1543	102	145	145	130	110	90	60
1545	124	172	172	160	140	110	75
1546	183	240	240	240	210	160	110

倒筒式蒸汽祛水器連續排水量表

IB STEAM TRAPS CAPACITY CHART

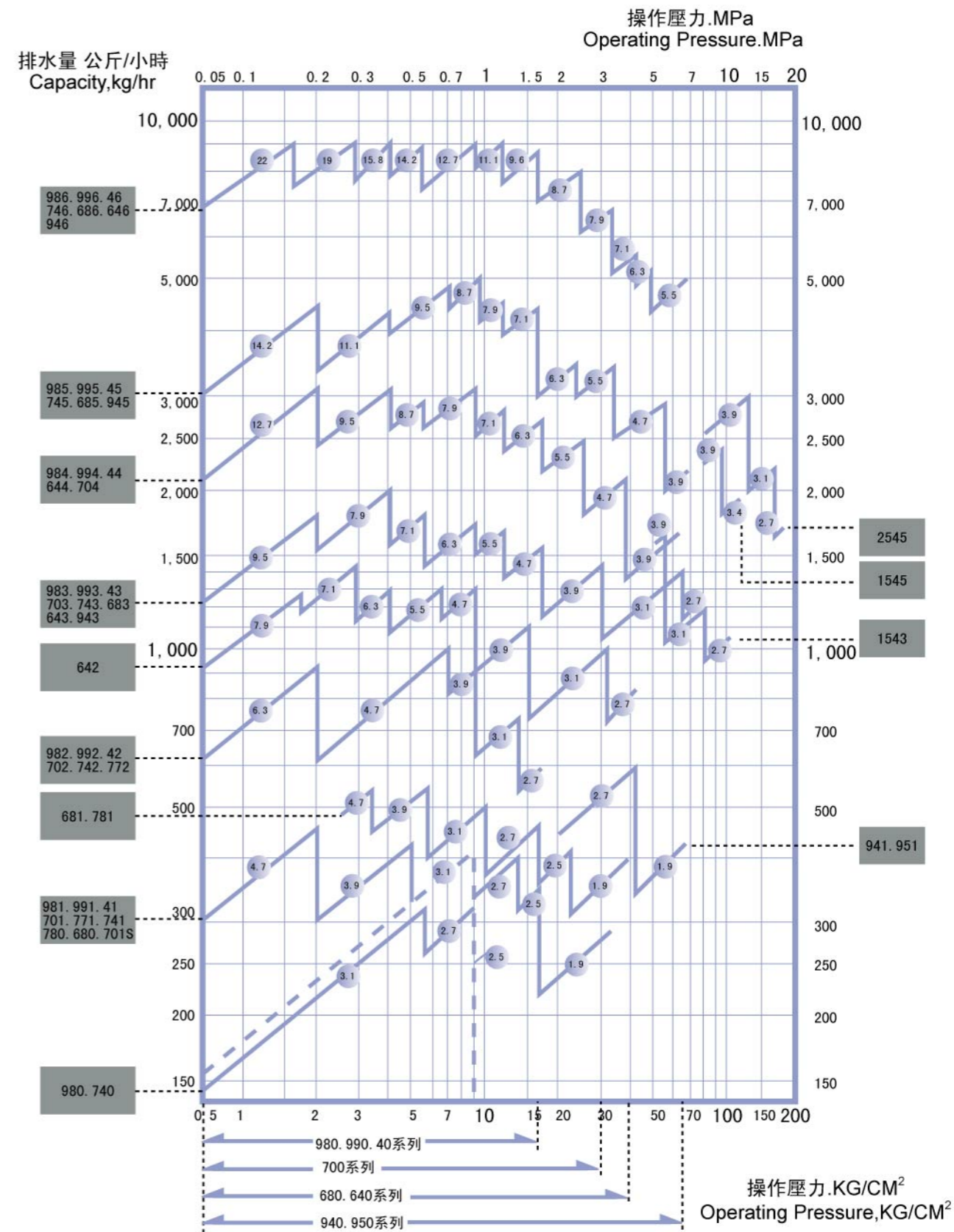

倒筒式蒸汽祛水器連續排水量表使用說明

IB STEAM TRAPS CAPACITY CHART INSTRUCTIONS

本圖是各型號倒筒式蒸汽祛水器、閘座全開連續冷凝水排量,小圓圈內為節流孔,<ORIFICE>直徑,如屬虛線內為981型,3.1mm節流孔,最高操作壓力9kg/cm²<0.9Mpa>範圍,排水量或操作壓力超出此範圍則不適用。選擇排水量時,要選排量較大的。

型號	節流孔	最高操作壓力kg/cm²
981	4.7mm	2
	3.9mm	5
	3.1mm	9
	2.7mm	13.5
	2.5mm	17
本體耐溫17kg/cm²x230°C		

例一、某蒸汽分配槽選裝蒸汽祛水器

最高操作壓力7kg/cm²,二部份鍋爐蒸氣量黃600kg/HR,祛水器排量按鍋爐總量1/3計200kg/HR.

由操作壓力7kg/cm²向上劃線,排水量由200kg/HR劃一線,交會點在980型2.7mm包容的範圍內,排量稍大的981型3.1mm,2.7mm,2.5mm

節流孔亦可適用。若要鑄鋼、不銹鋼本體有其他型如680或701型號等。

例二、某熱交換器選裝蒸汽祛水器

最高操作壓力10kg/cm²,最低操作壓力6kg/cm²,冷凝水量500kg/HRx3倍安全係數=1500kg/HR.

這時包容10kg/cm²x1500kg/HR與6kg/cm²x1500kg/HR二個交會點984,7.9mm節流孔或大一號的型號亦可。

例三、某熱交換器選裝蒸汽祛水器

最高操作壓力9kg/cm²,最高背壓4kg/cm²,冷凝水量200kg/HRx3倍安全係數=600kg/HR.

先由9kg/cm²x600kg/HR劃線,因為背壓有時不存在,在看差壓 $\Delta P=9\text{kg/cm}^2-4\text{kg/cm}^2=5\text{kg/cm}^2$ 5kg/cm²x600kg/HR選交會點982型3.9mm節流孔可包容比二交會點或大一號的型亦可。

鑄鋼倒筒式蒸汽祛水器

CAST STEEL INVERTED BUCKET TYPE STEAM TRAPS

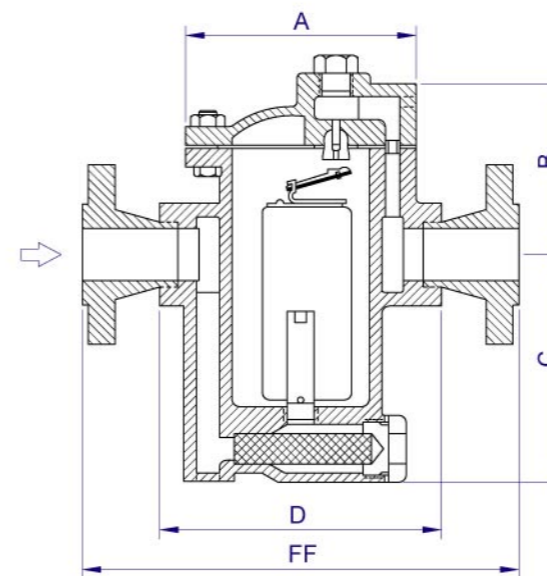

TRAP NO.680 SERIES DIMENSIONS. MOP. & WT.

TRAP NO.	CONN. SE*	A	B	C	D	MOP	WT
680	15.20	105	73	100	130	28	3
681	15.20.25	116	105	134	136	41	5
683	25.32.40	192	117	196	203	41	20
685	40.50	246	145	250	250	41	43
686	50.65.80	298	210	275	310	41	78

*可提供GZ NPT. PT. BSPT. 套焊連接.

-TRAP NO. 680系列蒸汽祛水器,管螺紋,焊口,側面進出,內附過濾器,可加裝不銹鋼逆止閘.

-*GZ NPT. PT. BSPT. socket weld connections available.

-TRAP NO. 680 series side in & side out. screwed or socket weld connections, with integral strainer

-TRAP NO. 680f are equipped with weld in flanges.

TRAP NO.680F SERIES FF DIMENSIONS.

TRAP NO.	CONN. FE*	150#	300#	600#
680F	15	216	216	
	20	228	234	
681F	15	219	219	229
	20	231	237	237
	25	236	245	245
683F	25	305	314	314
	40	316	324	327
685F	40	366	374	377
	50	372	385	391
686F	50	417	430	436
	65	430	442	449
	80	430	449	455

-ANSI B16.5, 150#RF, 300#RF, 600#RF flanges are standard, other flange spec. please consult factory, s.s. internal check valve can be fitted into trap body, pls add cv to trap no. all ib traps can be remodified to air service.

-TRAP NO. 680F 系列蒸汽祛水器,法蘭口,側面進出,內附過濾器,所有型號,均可改裝為倒筒式空氣祛水器,詳情請諮詢。

特徵 FEATURES:

最高操作壓力、溫度41kg/cm²(4.1mpa,600psi)x530°C

最大排量:9000kg/hr

鑄鋼外殼,耐壓高抗結凍;

適用於石化、電力、化工等較高要求場所;

可選管螺紋、焊口或各種法蘭口配合使用;

各型號均可改裝為鑄鋼倒筒式空氣祛水器;

側面進出,適宜中壓蒸汽使用、易於配管;

頂蓋上有管螺紋,可裝檢查凡爾,測試祛水器

Mop:41kg/cm²(4.1mpa,600psi)x530°C

Max. capacity:9000kg/hr.

Cast steel, high-pressure, anti-freeze;

Applicable to the petrochemical, electric station, chemical and so on;

Can be used with pipe thread weld end and different kinds of flange end;

Can be remodified to air service;

Side in and side out, appropriate using in medium pressure steam

材質表 MATERIALS LIST:

SIZE	部件名稱	PART NAME	材料	MATERIAL
1	本體	BODY	鑄鋼	ASTM A216MGR, WCB
2	機械結構	MECHANISM	不銹鋼	STAINLESS STEEL
3	倒筒	BUCKET	不銹鋼,5號以上加鑄鐵配重	STAINLESS STEEL. TRAP NO. 685&686 WITH CAST IRON WT.
4	閘座	SEAT	硬鉻鋼	HARDENED S.S 440C
5	內管	INLET TUBE	鋼重	STEEL PIPE
6	墊片	GASKET	非石棉	COMPRESSED NON-ASBESTOS
7	過濾器	STRAINER	不銹鋼	STAINLESS STEEL
8	螺絲	BOLTS	合金鋼	ASTM A193 GR.B7
9	螺帽	NUTS	合金鋼	ASTM A194 GR.2H

連續排水量表, 公斤/小時

CONTINUOUS DISCHARGE CAPACITY OF CONDENSATE IN KG/HR

TRAP NO	680	681	683	685	686	
	680F	681F	683F	685F	686F	
$\Delta P, \text{KG}/\text{CM}^2$	1	470	500	1,750	4,500	8,600
	2	460	500	1,800	4,500	8,150
	4	410	500	2,000	4,400	8,800
	6	385	430	1,500	4,300	7,700
	9	420	500	1,750	4,900	8,850
	10	365	520	1,550	4,500	8,450
	12	380	430	1,730	4,850	9,000
	15	335	450	1,500	4,700	8,400
	17	350	460	1,550	3,200	8,650
	20	240	400	1,250	3,500	7,300
	28	270	370	1,450	3,150	6,400
	34		390	1,050	3,400	7,050
	41		410	1,100	2,560	6,050

選擇時要考慮2~3倍的安全係數.

2-3 times safety factor of condensate load should always be considered to select proper steam traps.